

Building Entry Wall

SPECIFICATIONS

- 1 **Wall Graphic**
 Custom Full-Color Artwork, by Designer
 Digitally Printed Vinyl for Textured Wall
 V5 - w/ UV Matte Protective Overlamine
 Heat + Roller applied to wall surface
 - Per manufacturer spec.
- 2 **ID Letter**
 1/2" Thk. Cut Acrylic Letter
 1st surface P95 frosted finish on face,
 2nd Surface Backpainted - Paint P4
 VHB + Silicone Tape Mount to Wall Surface
- 3 **Graphic Panel**
 Custom Full-Color Artwork, by Designer
 Digitally Printed Vinyl on 1/4" Acrylic Panel
 V4 - w/ UV Matte Protective Overlamine
 VHB + Silicone Tape Mount to Wall Surface
- 4 **Level ID Panel**
 1/4" Thk. Acrylic Panel, Paint P3 All Surfaces
 w/ Cut + Applied Vinyl Lettering - Match V1
 VHB + Silicone Tape Mount to Wall Surface

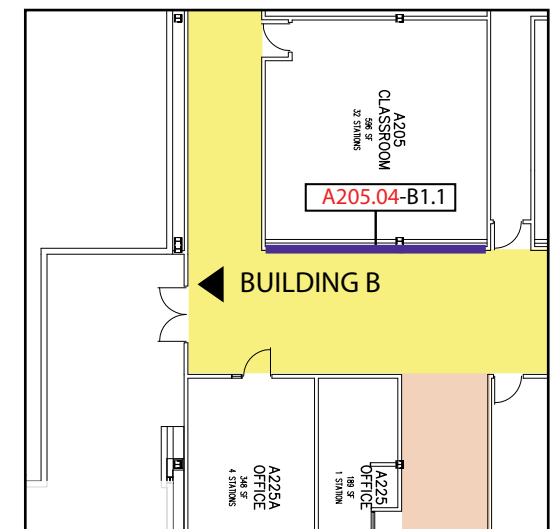
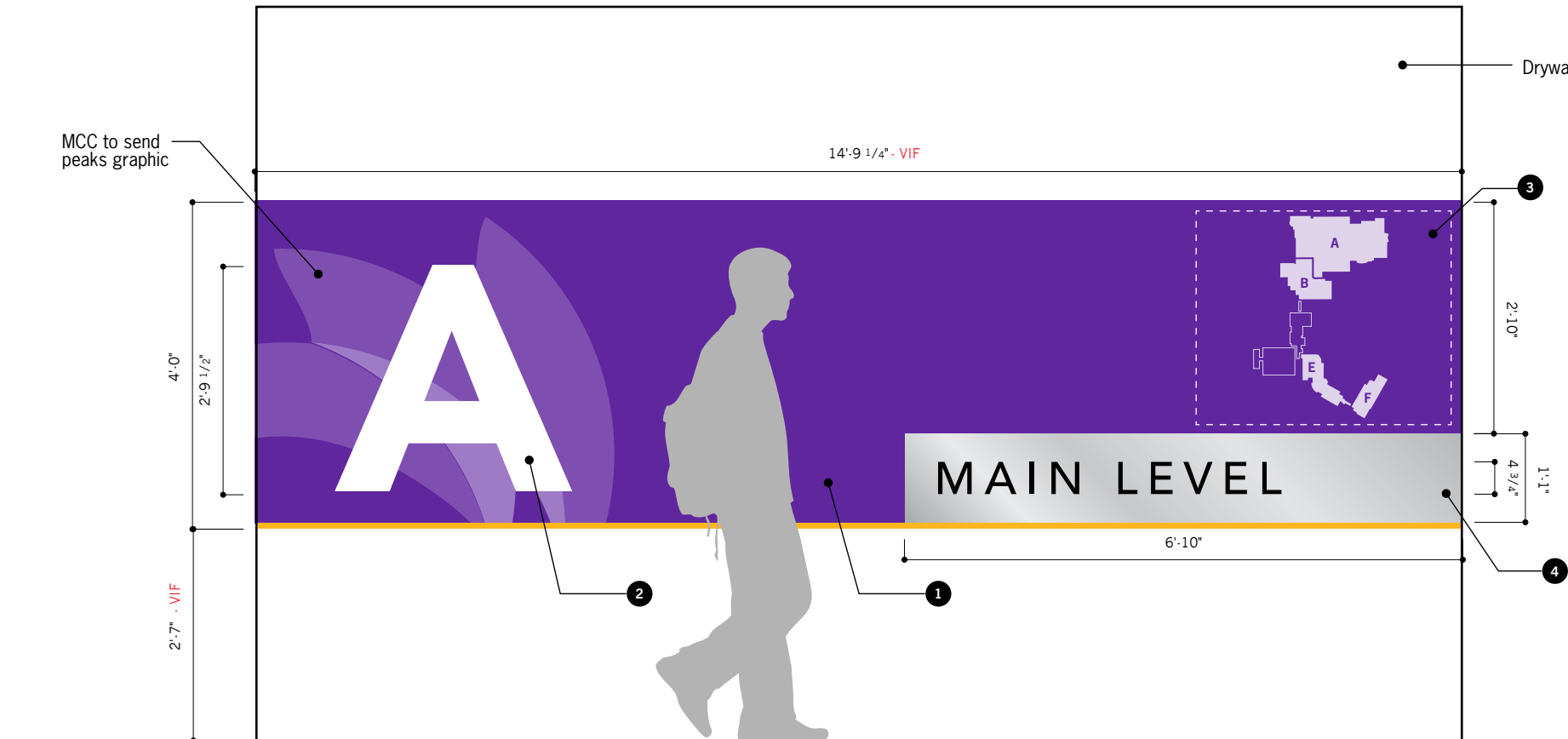

Building A Main Level
 Sign Location - A205.04 - B1.1

NOT AN EXACT ELEVATION
 Scale: 1/2" = 1'-0"

Building Entry Wall

SPECIFICATIONS

- 1 **Wall Graphic**
Custom Full-Color Artwork, by Designer
Digitally Printed Vinyl for Textured Wall
V5 - w/ UV Matte Protective Overlamine
Heat + Roller applied to wall surface
- Per manufacturer spec.
- 2 **ID Letter**
1/2" Thk. Cut Acrylic Letter
1st surface P95 frosted finish on face,
2nd Surface Backpainted - Paint P4
VHB + Silicone Tape Mount to Wall Surface
- 3 **Graphic Panel**
Custom Full-Color Artwork, by Designer
Digitally Printed Vinyl on 1/4" Acrylic Panel
V4 - w/ UV Matte Protective Overlamine
VHB + Silicone Tape Mount to Wall Surface
- 4 **Level ID Panel**
1/4" Thk. Acrylic Panel, Paint P3 All Surfaces
w/ Cut + Applied Vinyl Lettering - Match V1
VHB + Silicone Tape Mount to Wall Surface

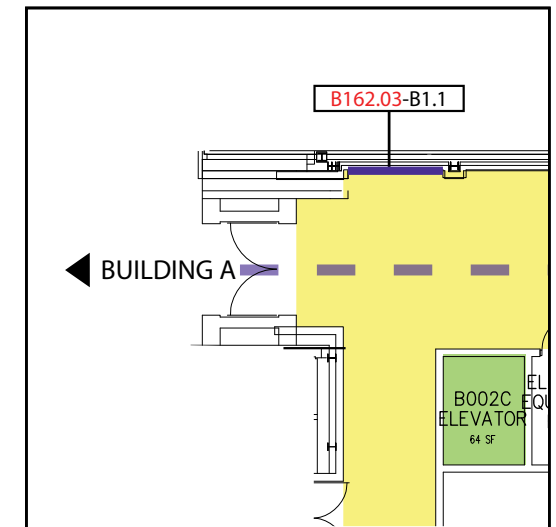
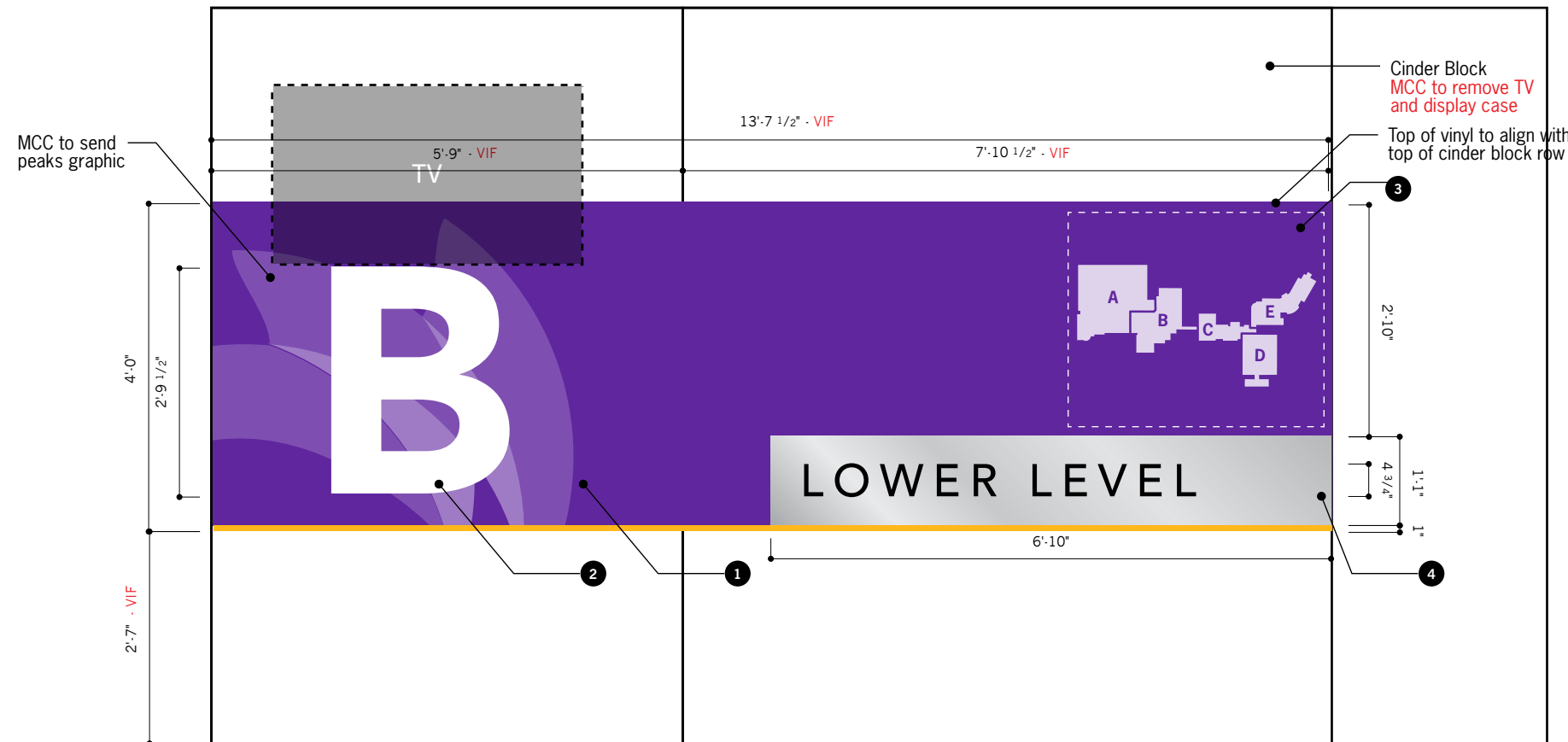

Building B Lower Level
Sign Location - B162.03 - B1.1

NOT AN EXACT ELEVATION
Scale: 1/2" = 1'-0"

Building Entry Wall

SPECIFICATIONS

- 1 Wall Graphic**
Custom Full-Color Artwork, by Designer
Digitally Printed Vinyl for Textured Wall
V5 - w/ UV Matte Protective Overlaminate
Heat + Roller applied to wall surface
- Per manufacturer spec.
- 2 ID Letter**
1/2" Thk. Cut Acrylic Letter
1st surface P95 frosted finish on face,
2nd Surface Backpainted - Paint P4
VHB + Silicone Tape Mount to Wall Surface
- 3 Graphic Panel**
Custom Full-Color Artwork, by Designer
Digitally Printed Vinyl on 1/4" Acrylic Panel
V4 - w/ UV Matte Protective Overlaminate
VHB + Silicone Tape Mount to Wall Surface
- 4 Level ID Panel**
1/4" Thk. Acrylic Panel, Paint P3 All Surfaces
w/ Cut + Applied Vinyl Lettering - Match V1
VHB + Silicone Tape Mount to Wall Surface

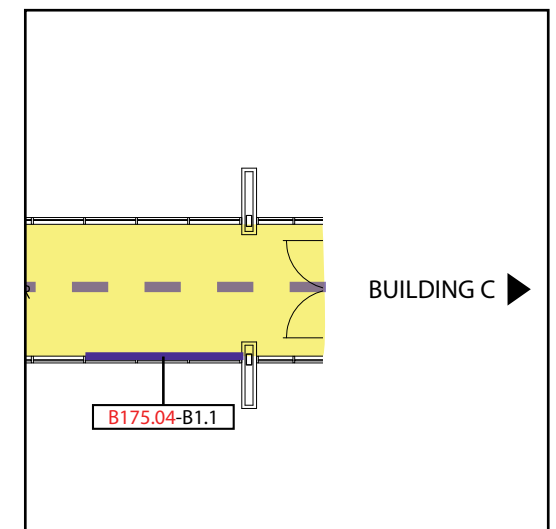
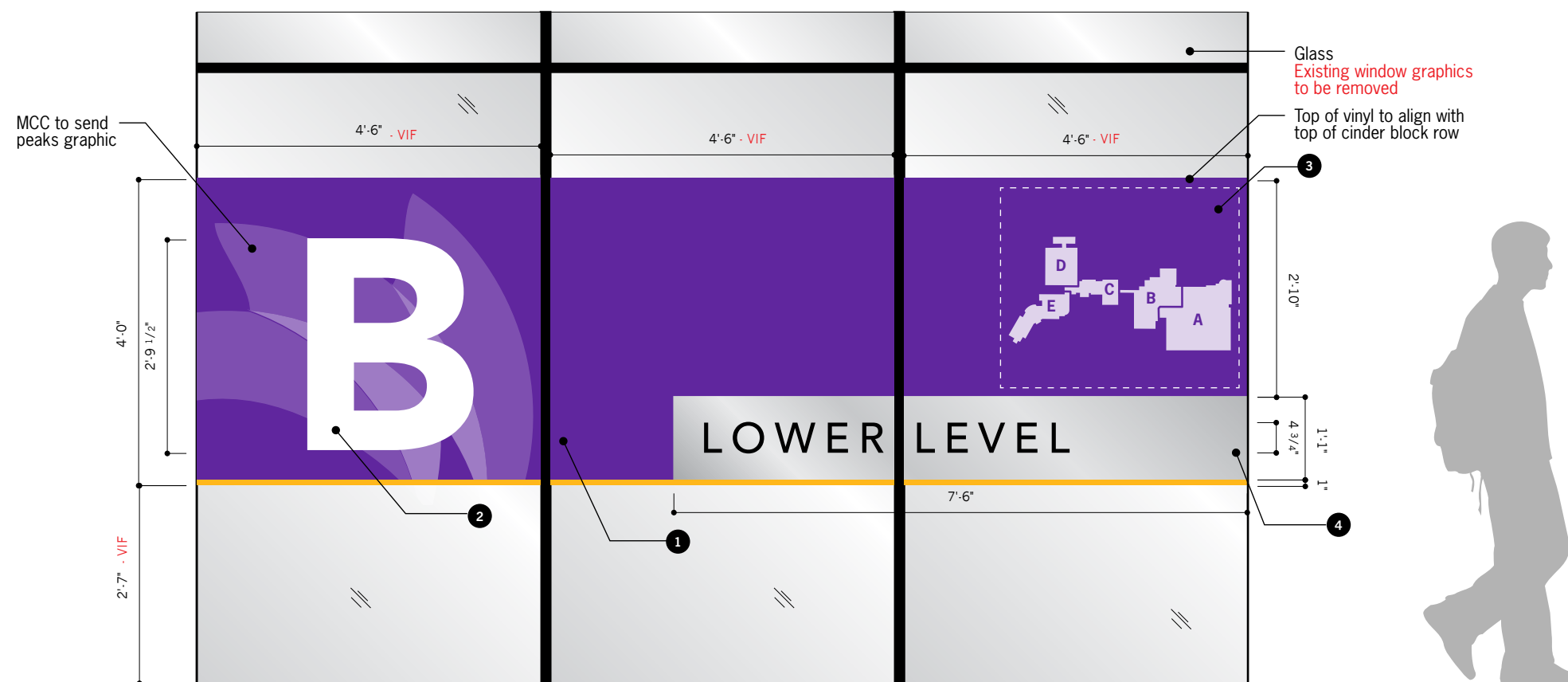

Building B Lower Level
Sign Location - B175.04 - B1.1

NOT AN EXACT ELEVATION
Scale: 1/2" = 1'-0"

Building Entry Wall

SPECIFICATIONS

- 1 **Wall Graphic**
Custom Full-Color Artwork, by Designer
Digitally Printed Vinyl for Textured Wall
V5 - w/ UV Matte Protective Overlaminate
Heat + Roller applied to wall surface
- Per manufacturer spec.
- 2 **ID Letter**
1/2" Thk. Cut Acrylic Letter
1st surface P95 frosted finish on face,
2nd Surface Backpainted - Paint P4
VHB + Silicone Tape Mount to Wall Surface
- 3 **Graphic Panel**
Custom Full-Color Artwork, by Designer
Digitally Printed Vinyl on 1/4" Acrylic Panel
V4 - w/ UV Matte Protective Overlaminate
VHB + Silicone Tape Mount to Wall Surface
- 4 **Level ID Panel**
1/4" Thk. Acrylic Panel, Paint P3 All Surfaces
w/ Cut + Applied Vinyl Lettering - Match V1
VHB + Silicone Tape Mount to Wall Surface

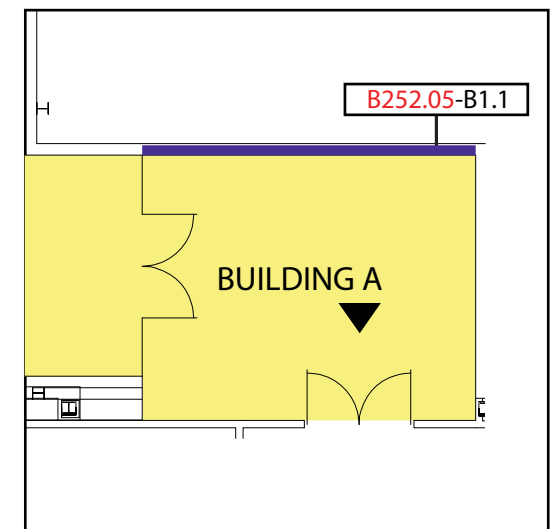
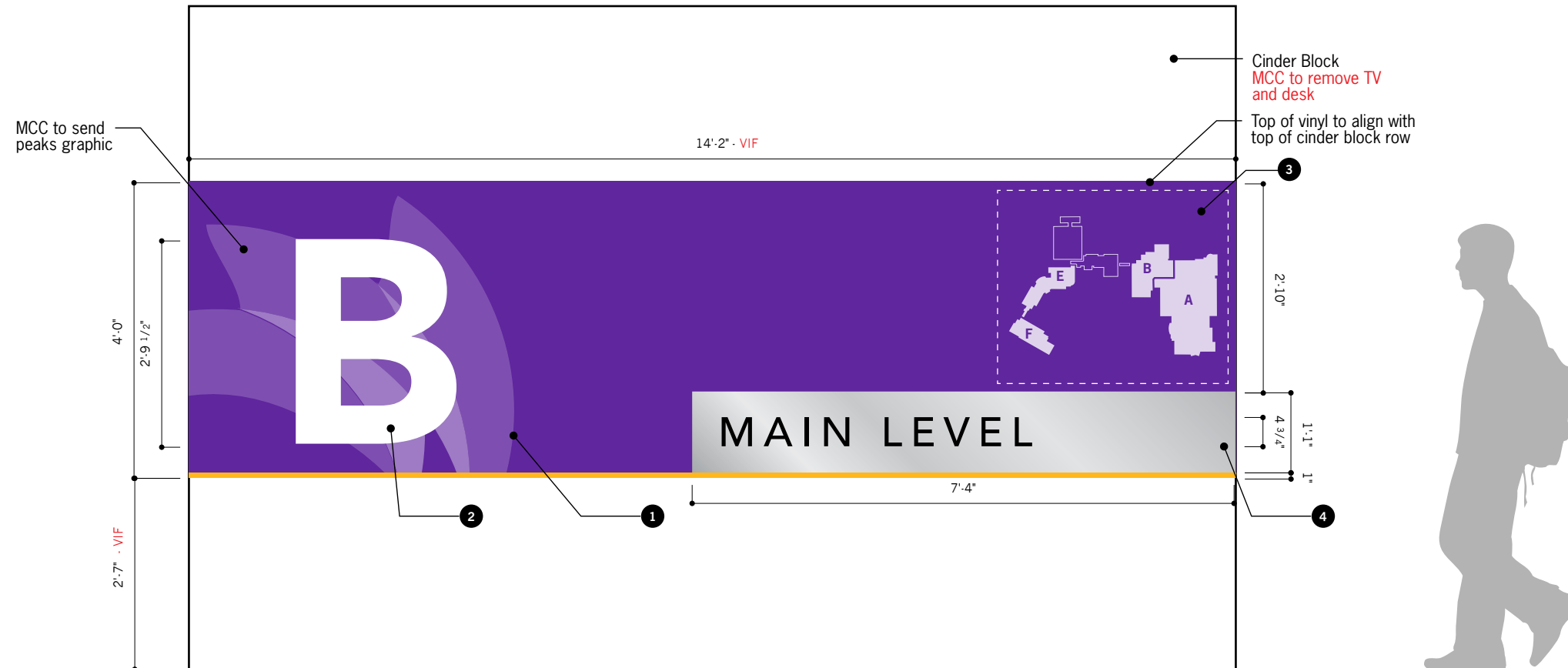

Building B Main Level
Sign Location - B252.05-B1.1

NOT AN EXACT ELEVATION
Scale: 1/2" = 1'-0"

Building Entry Wall

SPECIFICATIONS

- 1 **Wall Graphic**
Custom Full-Color Artwork, by Designer
Digitally Printed Vinyl for Textured Wall
V5 - w/ UV Matte Protective Overlamine
Heat + Roller applied to wall surface
- Per manufacturer spec.
- 2 **ID Letter**
1/2" Thk. Cut Acrylic Letter
1st surface P95 frosted finish on face,
2nd Surface Backpainted - Paint P4
VHB + Silicone Tape Mount to Wall Surface
- 3 **Graphic Panel**
Custom Full-Color Artwork, by Designer
Digitally Printed Vinyl on 1/4" Acrylic Panel
V4 - w/ UV Matte Protective Overlamine
VHB + Silicone Tape Mount to Wall Surface
- 4 **Level ID Panel**
1/4" Thk. Acrylic Panel, Paint P3 All Surfaces
w/ Cut + Applied Vinyl Lettering - Match V1
VHB + Silicone Tape Mount to Wall Surface

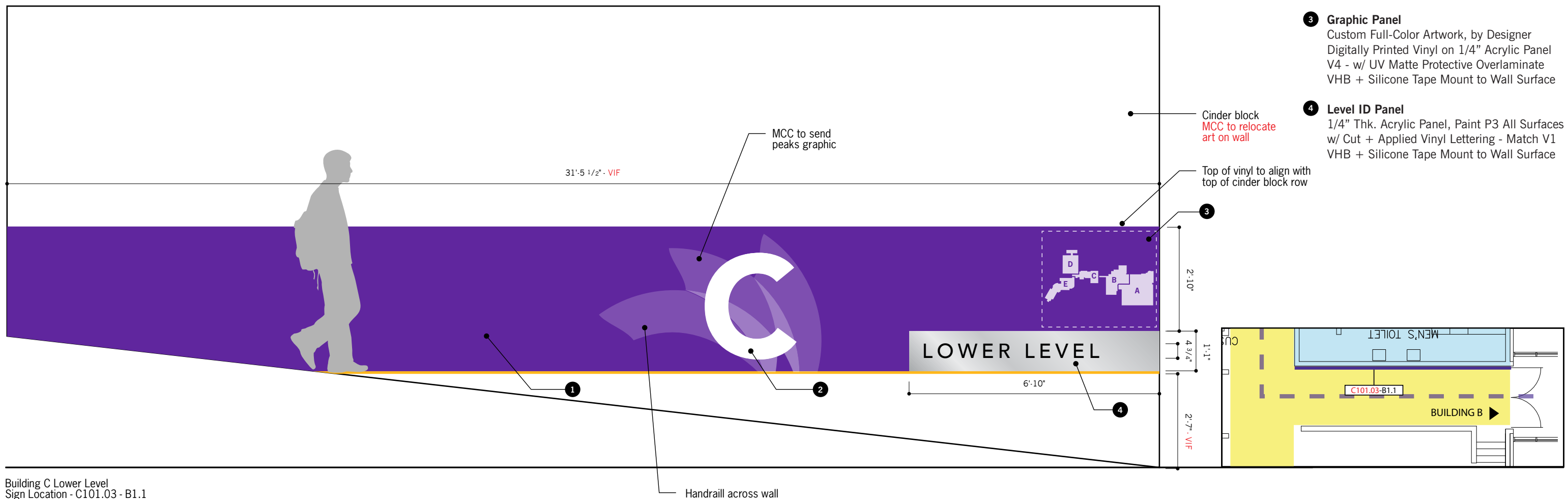

Building C Lower Level
Sign Location - C101.03 - B1.1

NOT AN EXACT ELEVATION
Scale: 3/8" = 1'-0"

Building Entry Wall



SPECIFICATIONS

- 1 **Wall Graphic**
Custom Full-Color Artwork, by Designer
Digitally Printed Vinyl for Textured Wall
V5 - w/ UV Matte Protective Overlaminate
Heat + Roller applied to wall surface
- Per manufacturer spec.
- 2 **ID Letter**
1/2" Thk. Cut Acrylic Letter
1st surface P95 frosted finish on face,
2nd Surface Backpainted - Paint P4
VHB + Silicone Tape Mount to Wall Surface
- 3 **Graphic Panel**
Custom Full-Color Artwork, by Designer
Digitally Printed Vinyl on 1/4" Acrylic Panel
V4 - w/ UV Matte Protective Overlaminate
VHB + Silicone Tape Mount to Wall Surface
- 4 **Level ID Panel**
1/4" Thk. Acrylic Panel, Paint P3 All Surfaces
w/ Cut + Applied Vinyl Lettering - Match V1
VHB + Silicone Tape Mount to Wall Surface

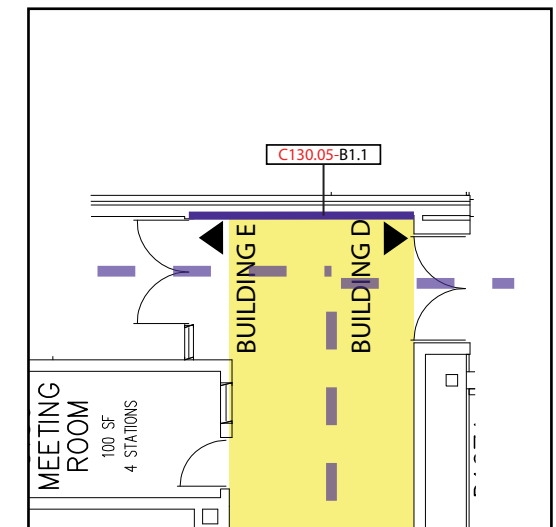
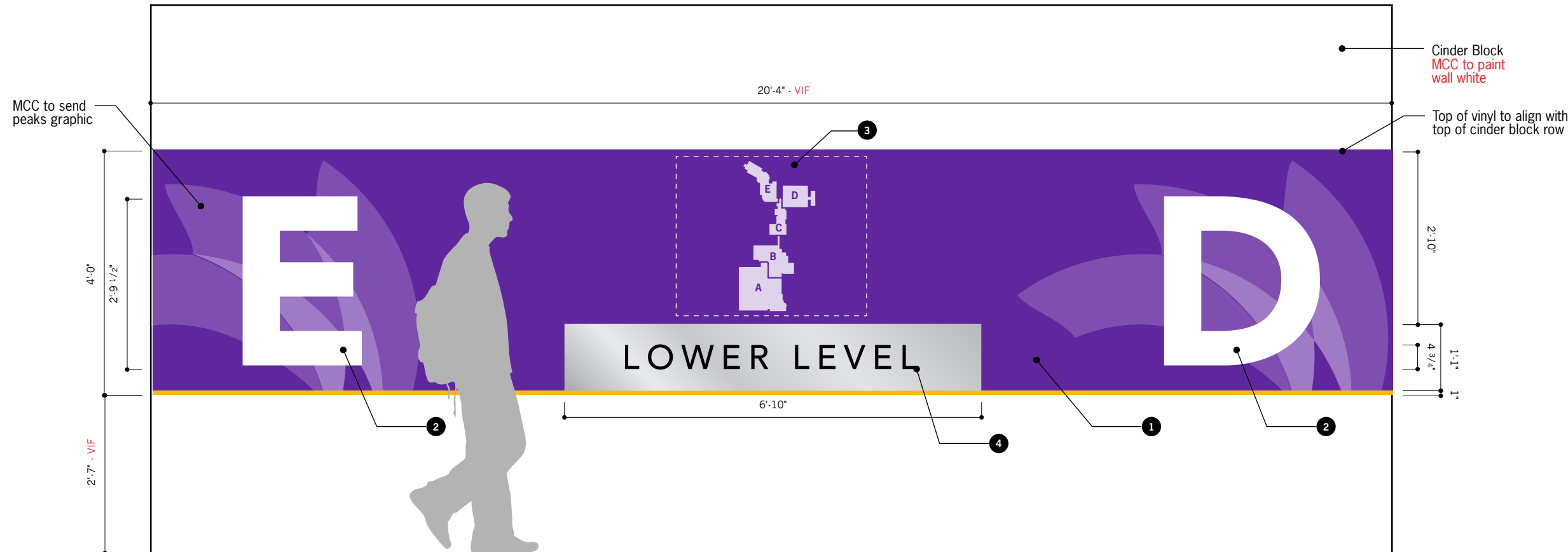

Building C Lower Level
Sign Location - C130.05-B1.1

NOT AN EXACT ELEVATION
Scale: 1/2" = 1'-0"

Building Entry Wall

SPECIFICATIONS

- 1 **Wall Graphic ***
 Custom Full-Color Artwork, by Designer
 Digitally Printed Vinyl for Textured Wall
 V5 - w/ UV Matte Protective Overlaminate
 Heat + Roller applied to wall surface
 - Per manufacturer spec.
- 2 **ID Letter**
 1/2" Thk. Cut Acrylic Letter
 1st surface P95 frosted finish on face,
 2nd Surface Backpainted - Paint P4
 VHB + Silicone Tape Mount to Wall Surface
- 3 **Graphic Panel**
 Custom Full-Color Artwork, by Designer
 Digitally Printed Vinyl on 1/4" Acrylic Panel
 V4 - w/ UV Matte Protective Overlaminate
 VHB + Silicone Tape Mount to Wall Surface
- 4 **Level ID Panel**
 1/4" Thk. Acrylic Panel, Paint P3 All Surfaces
 w/ Cut + Applied Vinyl Lettering - Match V1
 VHB + Silicone Tape Mount to Wall Surface

NOTE*
 For Irregular / Brick Wall Surface,
 Wall Graphic should be
 Digitally Printed Vinyl on 1/4" Acrylic Panel
 V4 - w/ UV Matte Protective Overlaminate
 Concealed Mechanical Fastener Mounted to Wall Surface

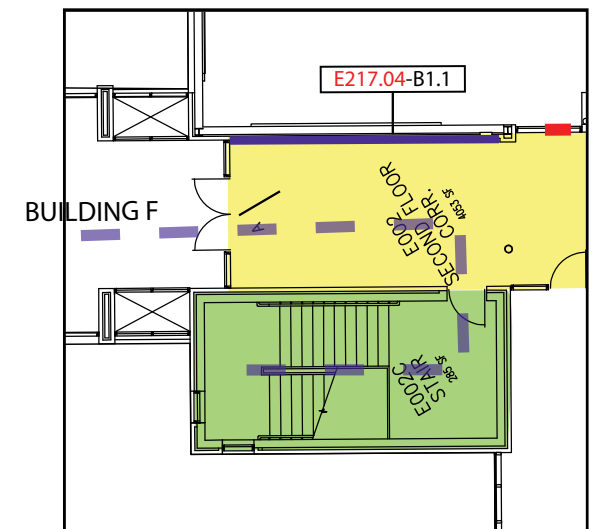
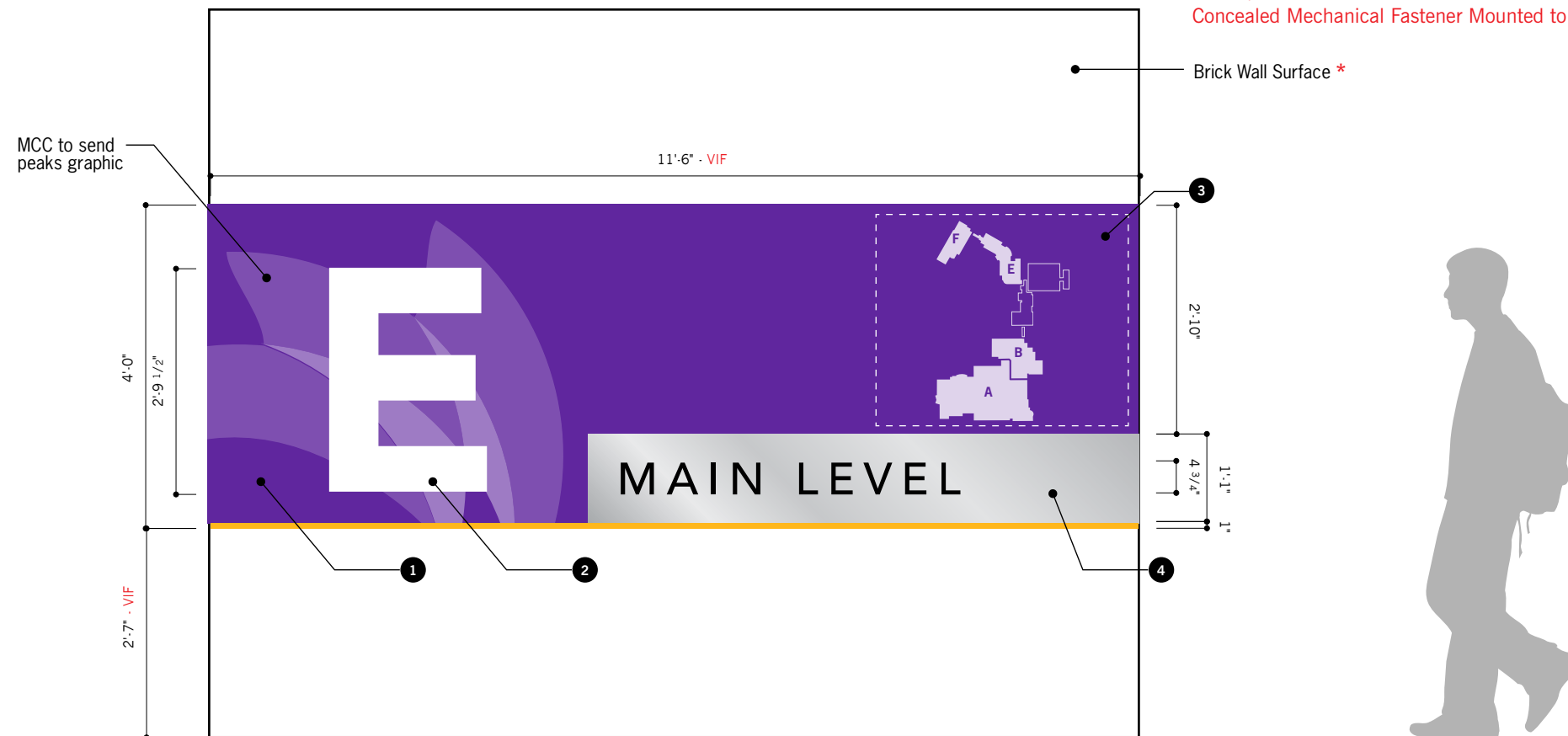

Building E Main Level
 Sign Location - E217.04-B1.1

NOT AN EXACT ELEVATION
 Scale: 1/2" = 1'-0"

Building Entry Wall

SPECIFICATIONS

- 1 **Wall Graphic**
 Custom Full-Color Artwork, by Designer
 Digitally Printed Vinyl for Textured Wall
 V5 - w/ UV Matte Protective Overlamine
 Heat + Roller applied to wall surface
 - Per manufacturer spec.
- 2 **ID Letter**
 1/2" Thk. Cut Acrylic Letter
 1st surface P95 frosted finish on face,
 2nd Surface Backpainted - Paint P4
 VHB + Silicone Tape Mount to Wall Surface
- 3 **Graphic Panel**
 Custom Full-Color Artwork, by Designer
 Digitally Printed Vinyl on 1/4" Acrylic Panel
 V4 - w/ UV Matte Protective Overlamine
 VHB + Silicone Tape Mount to Wall Surface
- 4 **Level ID Panel**
 1/4" Thk. Acrylic Panel, Paint P3 All Surfaces
 w/ Cut + Applied Vinyl Lettering - Match V1
 VHB + Silicone Tape Mount to Wall Surface

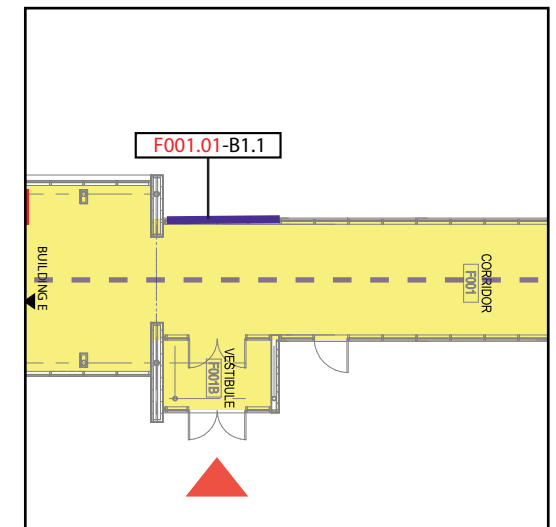
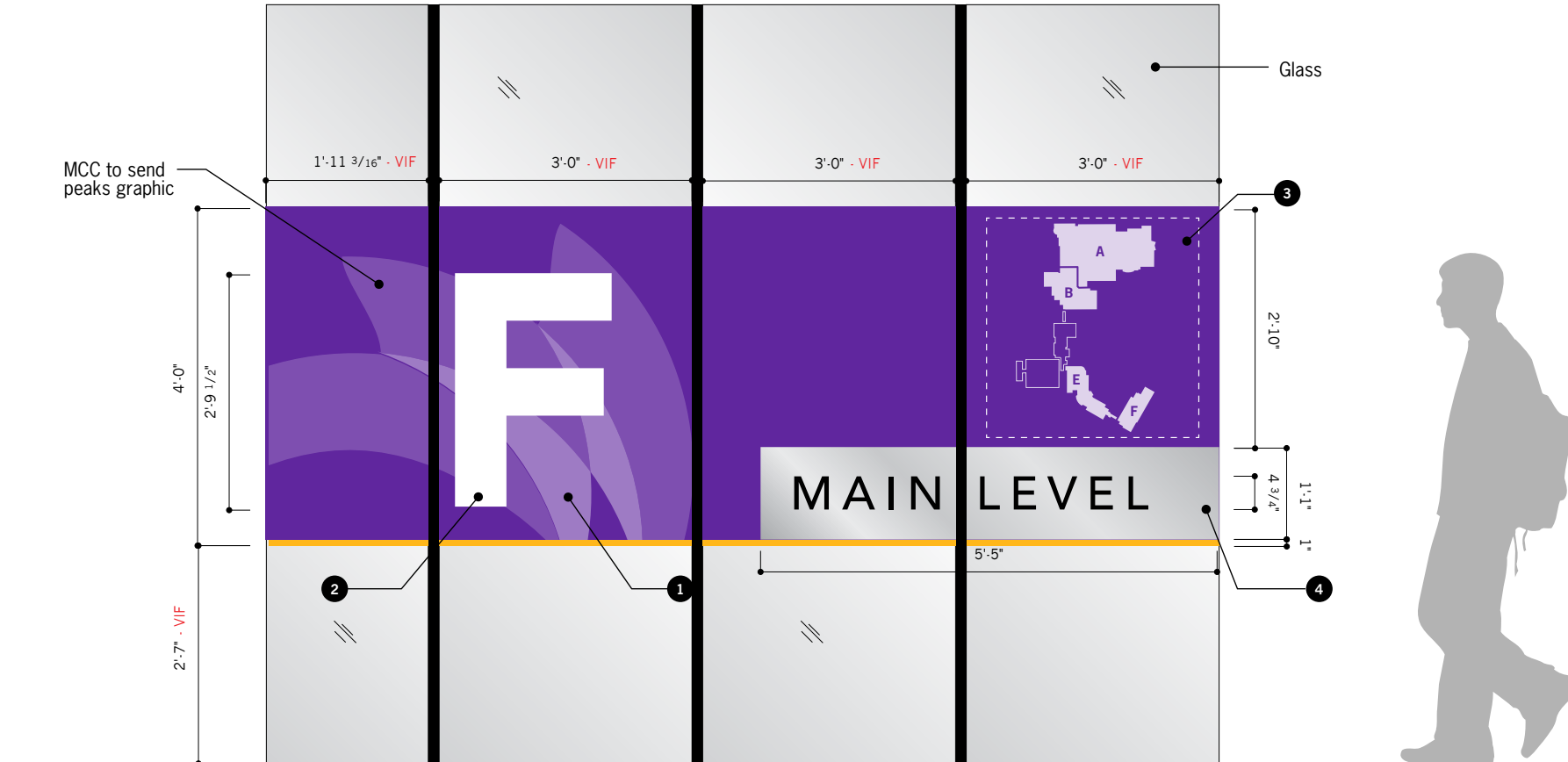

Building F Main Level
 Sign Location - F001.01-B1.1

NOT AN EXACT ELEVATION
 Scale: 1/2" = 1'-0"

SPECIFICATIONS

- 1 **Door Vinyls**
Cut Out Vinyl Material: V3
Mounting: Second Surface Applied

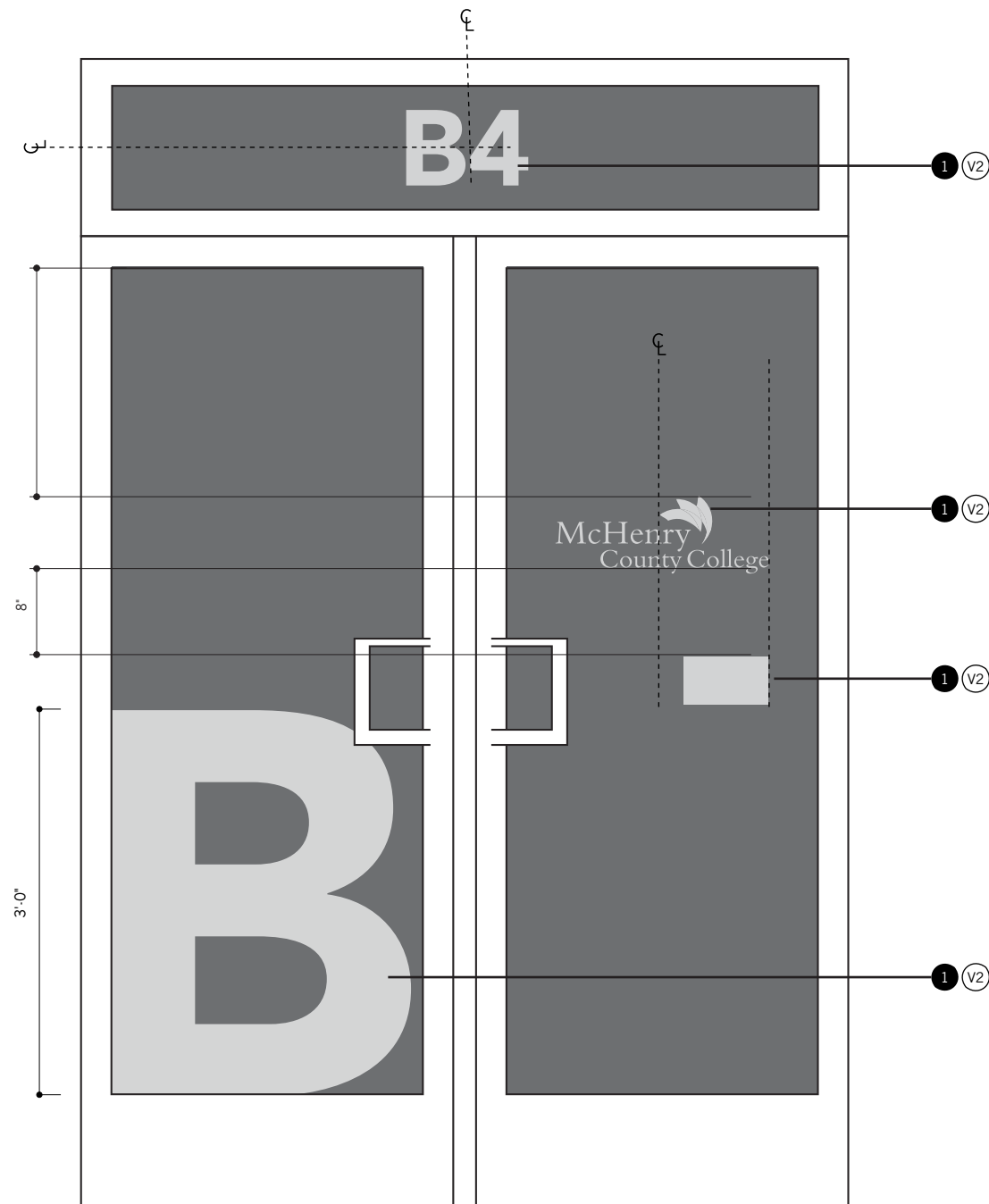

ELEVATION - V1 - V1.4 w/ Typical Specifications
Scale: 3/4" = 1'-0"

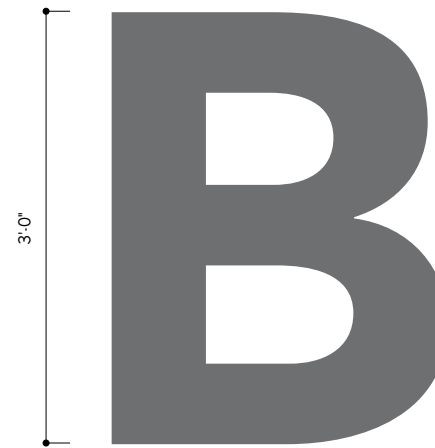

ELEVATION - V1
Scale: 3/4" = 1'-0"



ELEVATION - V2
Scale: 3/4" = 1'-0"



ELEVATION - V3
Scale: 3/4" = 1'-0"



ELEVATION - V4
Scale: 3/4" = 1'-0"

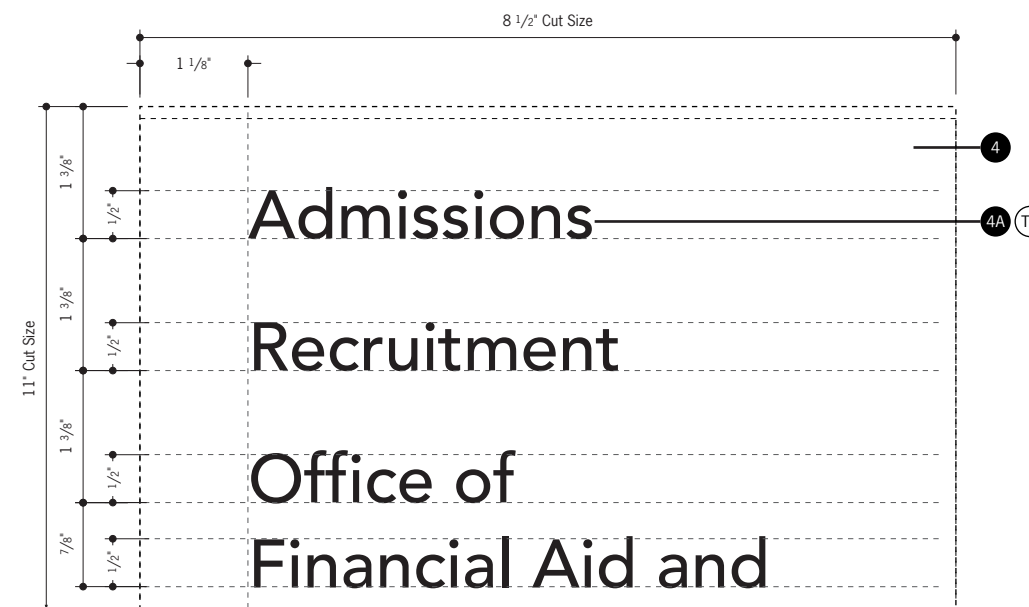
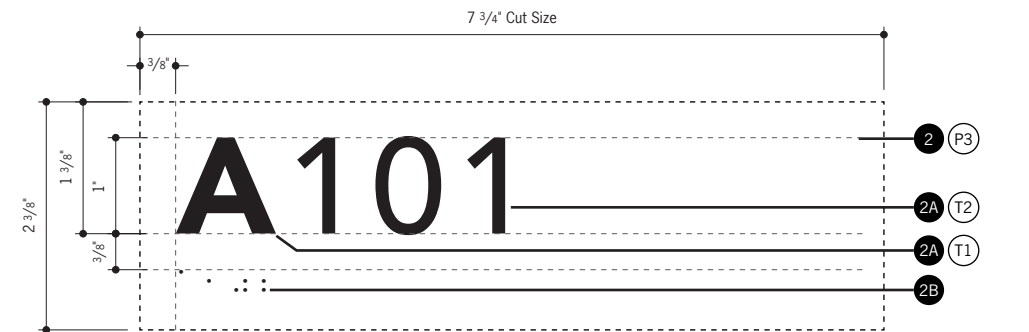
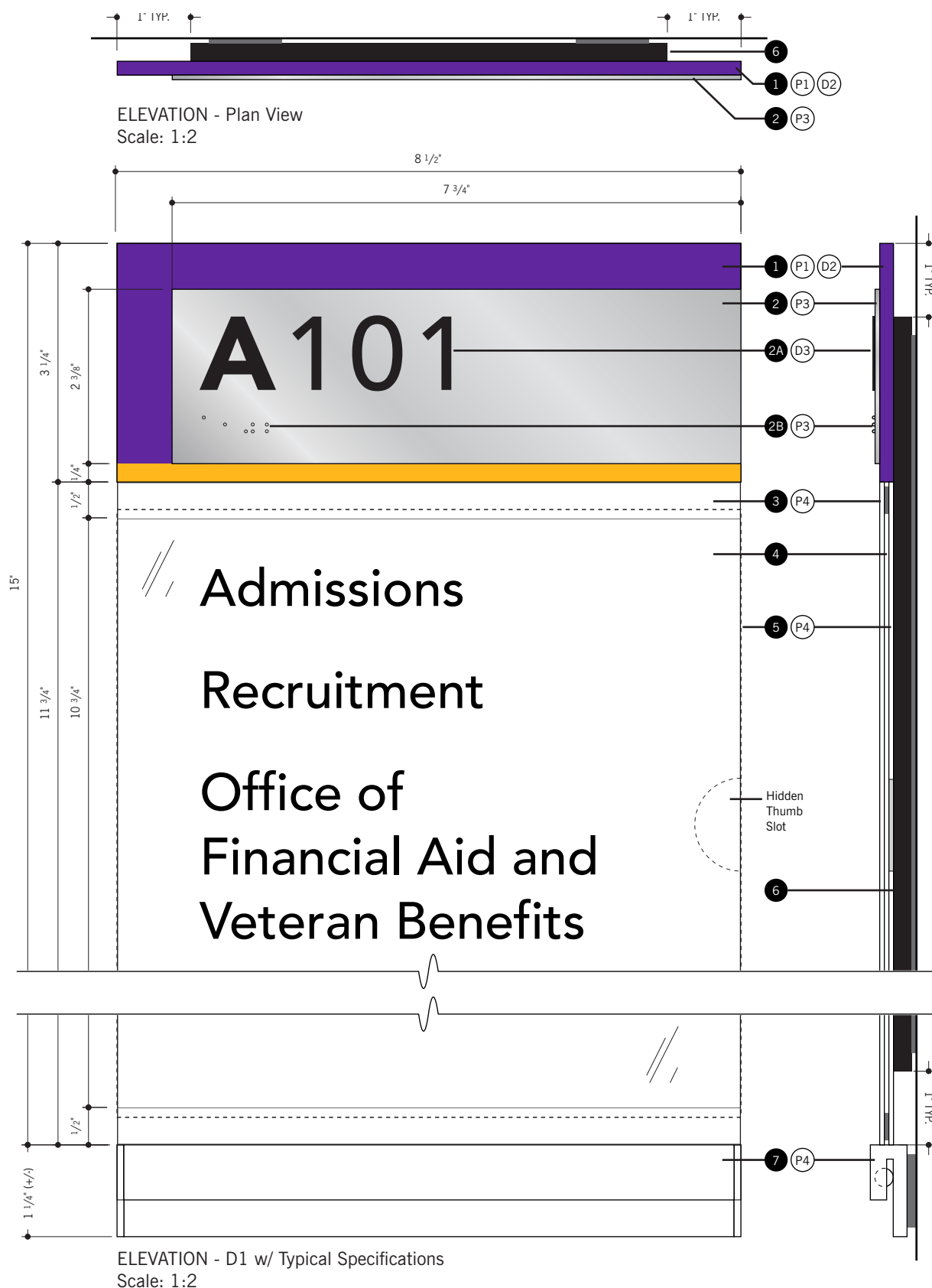

SPECIFICATIONS

- 1 Header Panel**
 Material: 3/16" Thk. Acrylic
 Printing: Custom Rule Line - Match D2
 Color: Painted - Match P1
 Mounting: Secure to Back Plate w/ removable fasteners
- 2 ADA Panel**
 Material: 1/16" Thk. Photopolymer
 Printing: Raised Copy Only - Match D3
 Color: Painted - Match P3
 Mounting: Laminated to Header Panel
- 2A ADA Copy - Lettering**
 Raised Photopolymer
 Typeface: T1/T2
 Size: 1" Cap Height
 Case: Upper Case Only
 Tracking: +75
- 2B ADA Copy - Braille**
 Raised Photopolymer, Redundant Grade 2 Braille Copy
 Color: Match ADA Insert
- 3 Paper Insert Lens**
 Material: 1/16" Thk. Clear Non-Glare Acrylic
 Color: Mask + Spray 2nd Surface Band - Match P4
 Mounting: 1/16" D/F Tape Mount to Insert Backer
- 4 Paper Insert**
 Color: A00 White, Per Sign Standard
- 4A Insert Copy**
 Laser Printed Graphics - See Graphic Layouts
 Color: S1
 Typeface: T2
 Size: 1/2" Cap Height
 Case: Upper/Lower
 Tracking: 0
- 5 Paper Insert Backer**
 Material: 1/16" Thk. Acrylic
 Color: Paint P4 - All Surfaces
 Mounting: Laminated to Back Plate
- 6 Back Plate**
 Material: 1/4" Thk. #2025 Opaque Black Acrylic
 Mounting: Concealed Mechanical Fasteners to Wall
- 7 Paper Holder**
 Product: NMS Notifier - by APCO
 Color: Paint P4 - All Surfaces
 Mounting: 1/8" VHB Tape to Wall Surface as reqd.

SPECIFICATIONS

- 1 Header Panel**
 Material: 3/16" Thk. Acrylic
 Printing: Custom Rule Line - Match D2
 Color: Painted - Match P1
 Mounting: Secure to Back Plate w/ removable fasteners
- 2 ADA Panel**
 Material: 1/16" Thk. Photopolymer
 Printing: Raised Copy Only - Match D3
 Color: Painted - Match P3
 Mounting: Laminated to Header Panel
- 2A ADA Copy - Lettering**
 Raised Photopolymer
 Typeface: T1/T2
 Size: 1" Cap Height
 Case: Upper Case Only
 Tracking: +75
- 2B ADA Copy - Braille**
 Raised Photopolymer, Redundant Grade 2 Braille Copy
 Color: Match ADA Insert
- 3 Paper Insert Lens**
 Material: 1/16" Thk. Clear Non-Glare Acrylic
 Color: Mask + Spray 2nd Surface Band - Match P4
 Mounting: 1/16" D/F Tape Mount to Insert Backer
- 4 Paper Insert**
 Color: A00 White, Per Sign Standard
- 4A Insert Copy**
 Laser Printed Graphics - See Graphic Layouts
 Color: S1
 Typeface: T2
 Size: 1/2" Cap Height
 Case: Upper/Lower
 Tracking: 0
- 5 Paper Insert Backer**
 Material: 1/16" Thk. Acrylic
 Color: Paint P4 - All Surfaces
 Mounting: Laminated to Back Plate
- 6 Back Plate**
 Material: 1/4" Thk. #2025 Opaque Black Acrylic
 Mounting: Concealed Mechanical Fasteners to Wall
- 7 Paper Holder**
 Product: NMS Notifier - by APCO
 Color: Paint P4 - All Surfaces
 Mounting: 1/8" VHB Tape to Wall Surface as reqd.

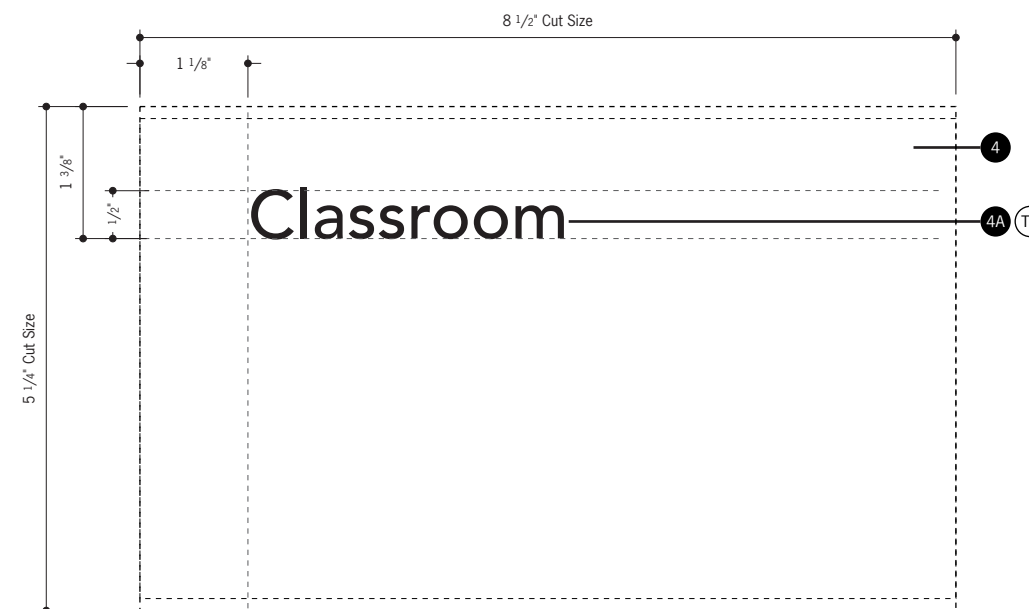
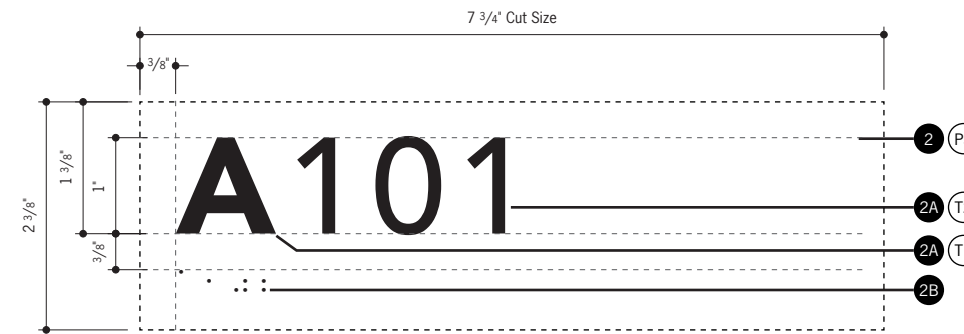
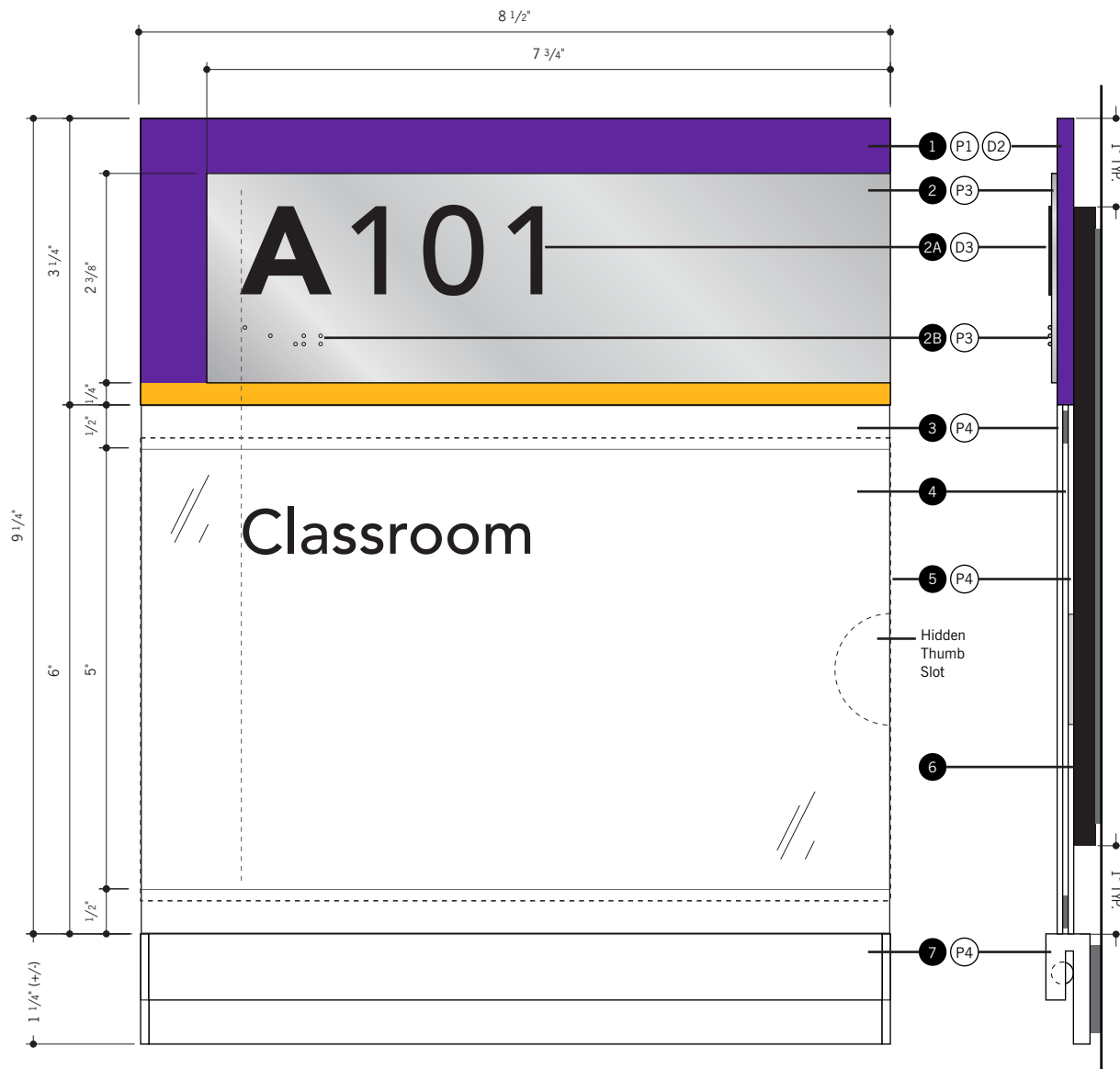

SPECIFICATIONS

- 1 Header Panel**
 Material: 3/16" Thk. Acrylic
 Printing: Custom Rule Line - Match D2
 Color: Painted - Match P1
 Mounting: Secure to Back Plate w/ removable fasteners
- 2 ADA Panel**
 Material: 1/16" Thk. Photopolymer
 Printing: Raised Copy Only - Match D3
 Color: Painted - Match P3
 Mounting: Laminated to Header Panel
- 2A ADA Copy - Lettering**
 Raised Photopolymer
 Typeface: T1/T2
 Size: 1" Cap Height
 Case: Upper Case Only
 Tracking: +75
- 2B ADA Copy - Braille**
 Raised Photopolymer, Redundant Grade 2 Braille Copy
 Color: Match ADA Insert
- 3 Paper Insert Lens**
 Material: 1/16" Thk. Clear Non-Glare Acrylic
 Color: Mask + Spray 2nd Surface Band - Match P4
 Mounting: 1/16" D/F Tape Mount to Insert Backer
- 4 Paper Insert**
 Color: A00 White, Per Sign Standard
- 4A Insert Copy**
 Laser Printed Graphics - See Graphic Layouts
 Color: S1
 Typeface: T2
 Size: 1/2" Cap Height
 Case: Upper/Lower
 Tracking: 0
- 5 Paper Insert Backer**
 Material: 1/16" Thk. Acrylic
 Color: Paint P4 - All Surfaces
 Mounting: Laminated to Back Plate
- 6 Back Plate**
 Material: 1/4" Thk. #2025 Opaque Black Acrylic
 Mounting: Concealed Mechanical Fasteners to Wall
- 7 Paper Holder**
 Product: NMS Notifier - by APCO
 Color: Paint P4 - All Surfaces
 Mounting: 1/8" VHB Tape to Wall Surface as reqd.

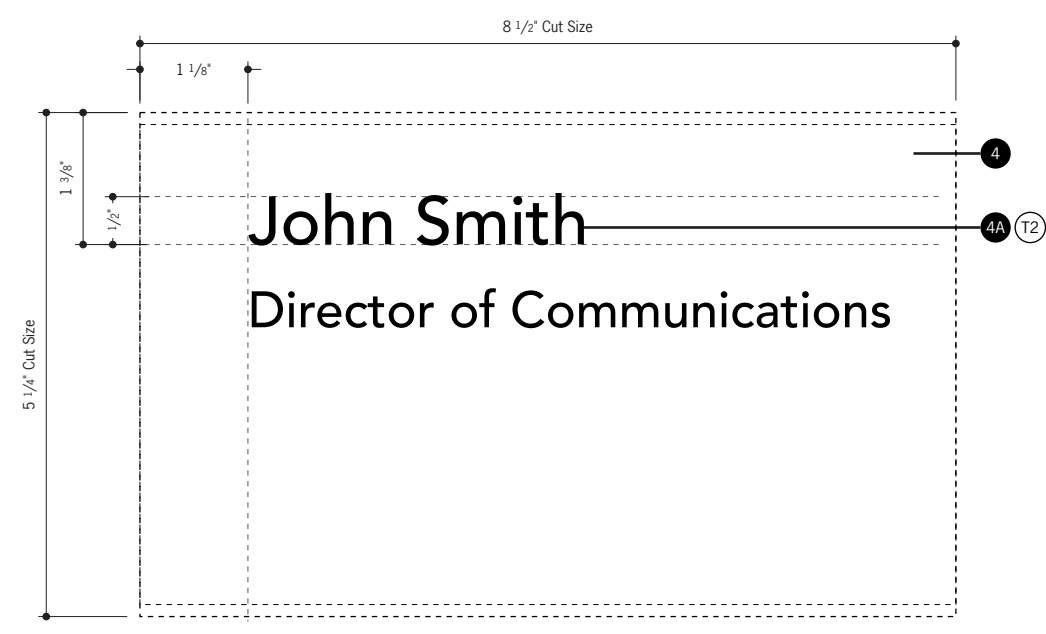
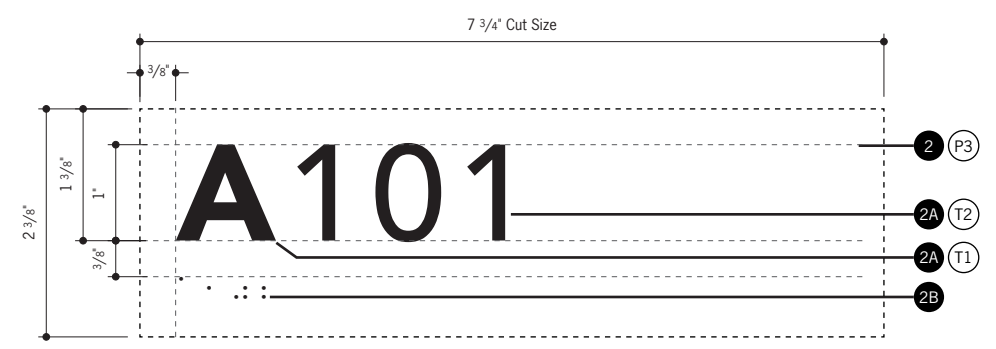
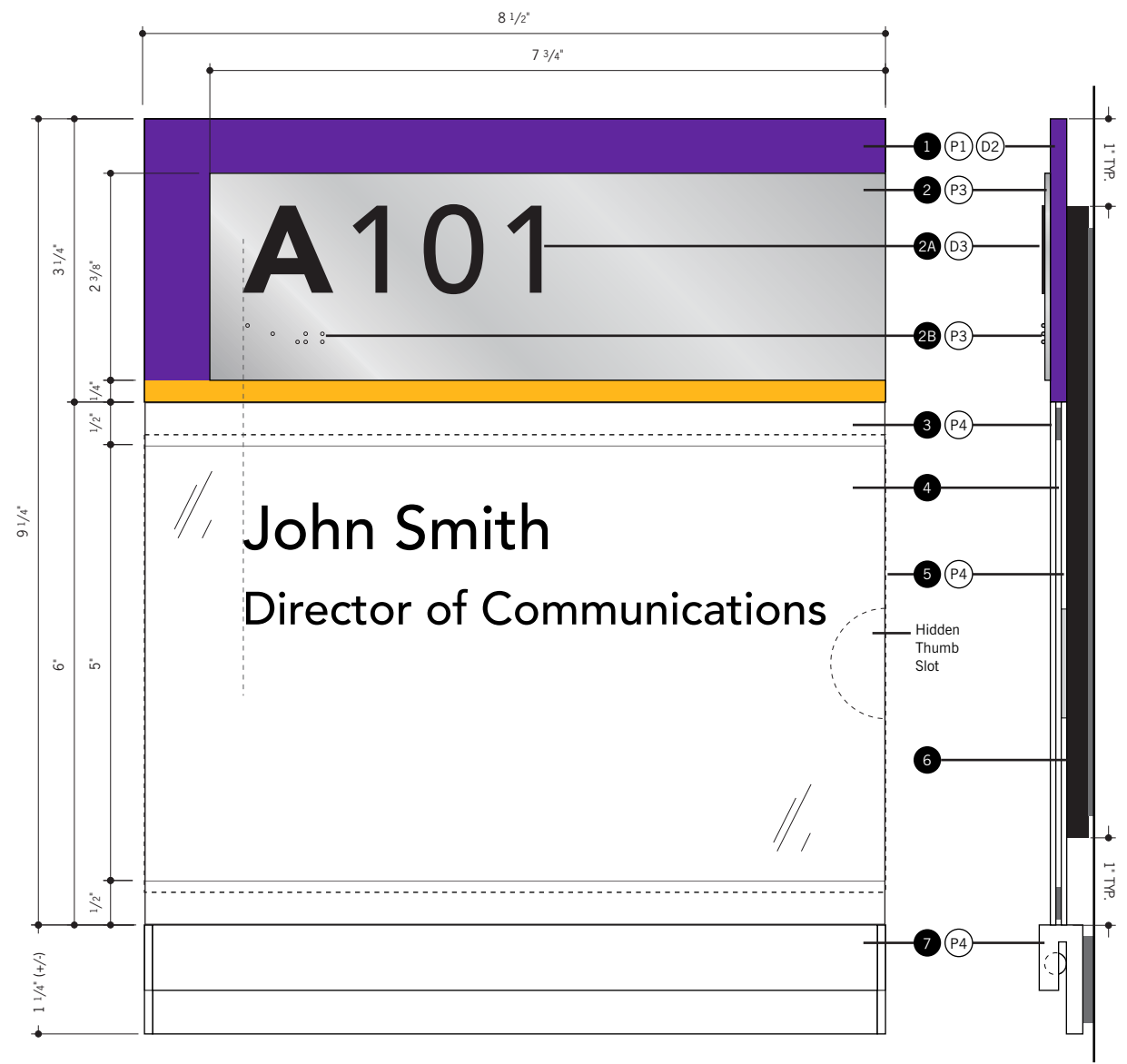

SPECIFICATIONS

- 1 Header Panel**
 Material: 3/16" Thk. Acrylic
 Printing: Custom Rule Line - Match D2
 Color: Painted - Match P1
 Mounting: Secure to Back Plate w/ removable fasteners
- 2 ADA Panel**
 Material: 1/16" Thk. Photopolymer
 Printing: Raised Copy Only - Match D3
 Color: Painted - Match P3
 Mounting: Laminated to Header Panel
- 2A ADA Copy - Lettering**
 Raised Photopolymer
 Typeface: T1/T2
 Size: 1" Cap Height
 Case: Upper Case Only
 Tracking: +75
- 2B ADA Copy - Braille**
 Raised Photopolymer, Redundant Grade 2 Braille Copy
 Color: Match ADA Insert
- 3 Paper Insert Lens**
 Material: 1/16" Thk. Clear Non-Glare Acrylic
 Color: Mask + Spray 2nd Surface Band - Match P4
 Mounting: 1/16" D/F Tape Mount to Insert Backer
- 4 Paper Insert**
 Color: A00 White, Per Sign Standard
- 4A Insert Copy**
 Laser Printed Graphics - See Graphic Layouts
 Color: S1
 Typeface: T2
 Size: 1/2" Cap Height
 Case: Upper/Lower
 Tracking: 0
- 5 Paper Insert Backer**
 Material: 1/16" Thk. Acrylic
 Color: Paint P4 - All Surfaces
 Mounting: Laminated to Back Plate
- 6 Back Plate**
 Material: 1/4" Thk. #2025 Opaque Black Acrylic
 Mounting: Concealed Mechanical Fasteners to Wall
- 7 Paper Holder**
 Product: NMS Notifier - by APCO
 Color: Paint P4 - All Surfaces
 Mounting: 1/8" VHB Tape to Wall Surface as reqd.

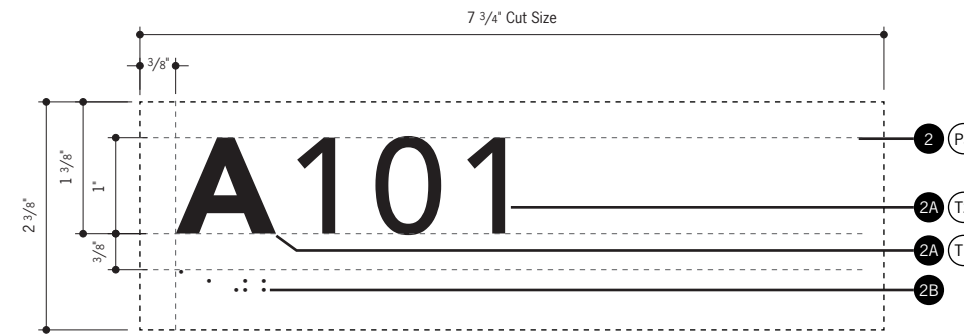
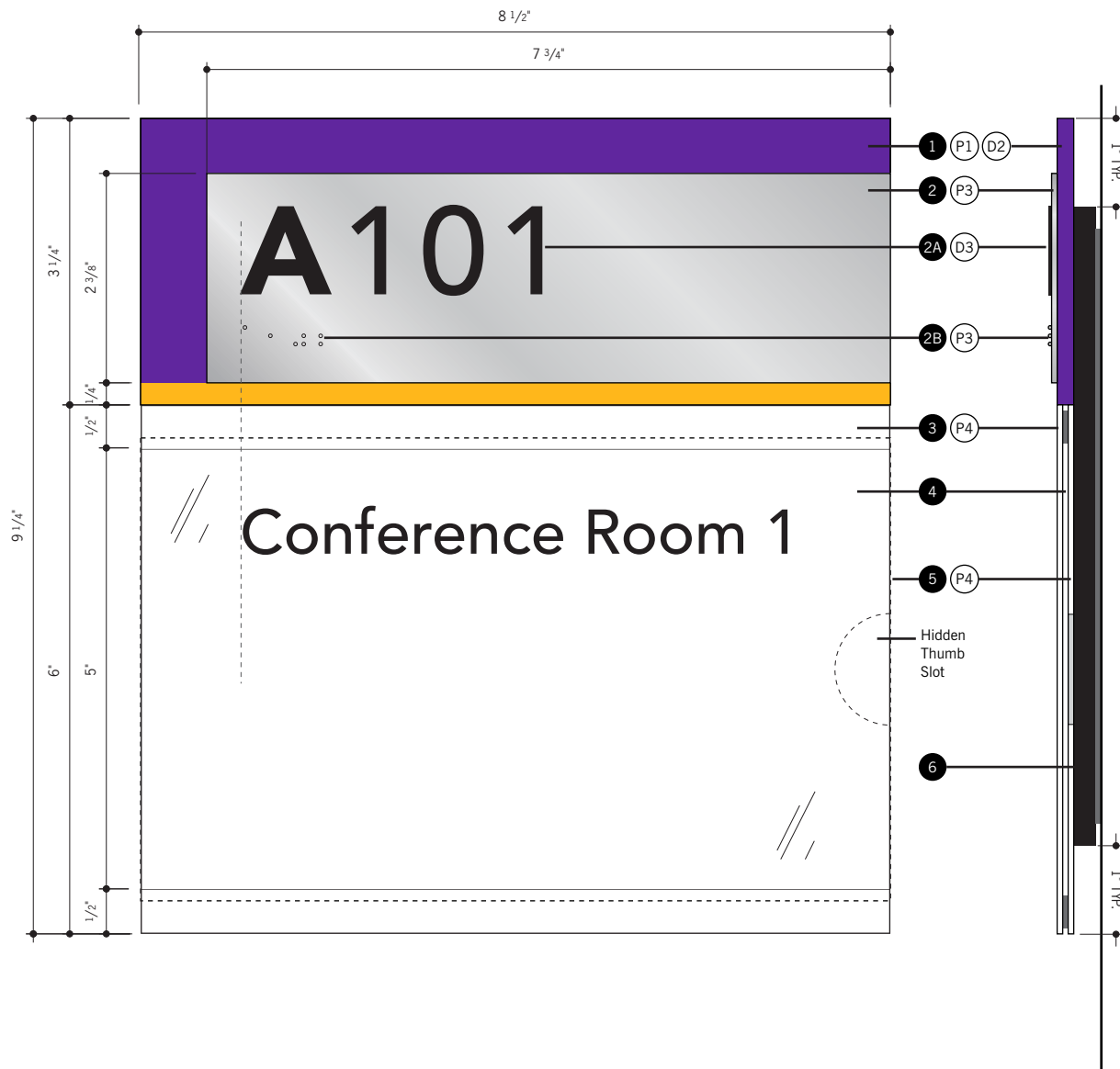



ELEVATION - Plan View
Scale: 1:2



ELEVATION - D5 w/ Typical Specifications
Scale: 1:2

SPECIFICATIONS

- 1 Symbol Panel**
 Material: 3/16" Thk. Acrylic
 Color: Painted - Panel and edges painted P4
 Printing: Match D3 / D4
 Mounting: Secure to Back Plate w/ removable fasteners
- 2 ADA Panel**
 Material: 3/16" Thk. Photopolymer
 Printing: Raised Copy Only - Match D3
 Color: Painted - Match P3
 Rule Line: Mask + Spray - Paint P2
 Mounting: Secure to Back Plate w/ removable fasteners
- 2A ADA Copy - Lettering**
 Raised Photopolymer
 Typeface: T1/T2
 Size: 5/8" Cap Height
 Case: Upper Case Only
 Tracking: +75
- 2B ADA Copy - Braille**
 Raised Photopolymer, Redundant Grade 2 Braille Copy
 Color: Match ADA Insert
- 3 Back Plate**
 Material: 1/4" Thk. #2025 Opaque Black Acrylic
 Mounting: Concealed Mechanical Fasteners to Wall

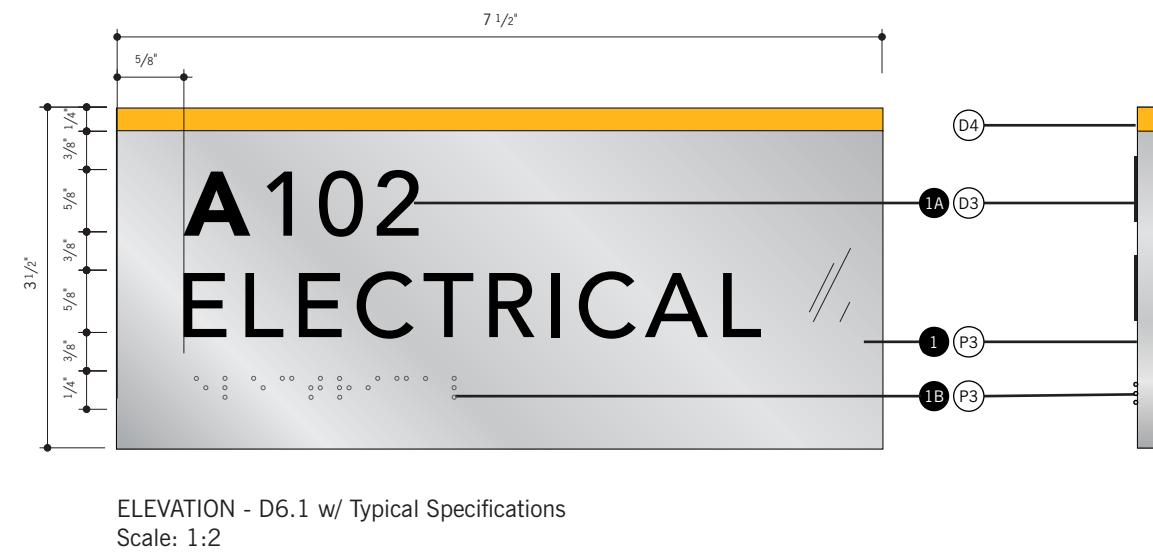
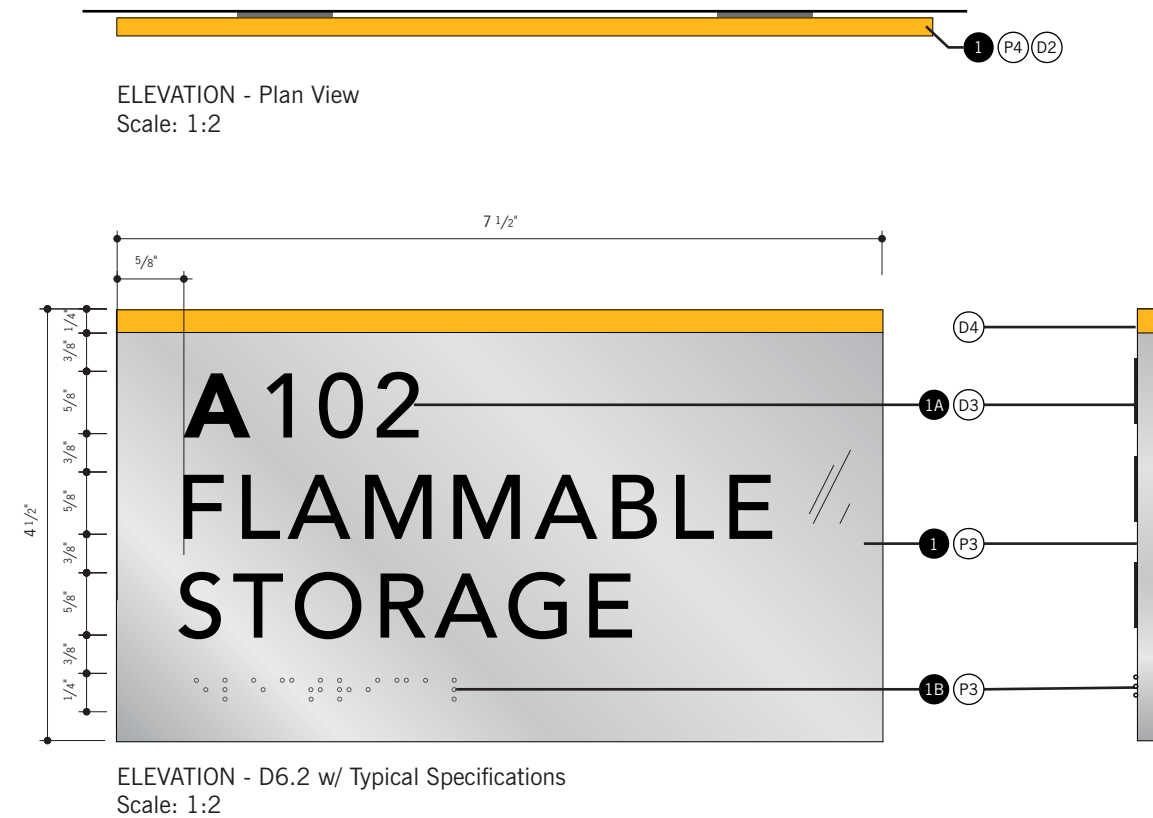

SPECIFICATIONS

- 1 ADA Panel**
 Material: 3/16" Thk. Photopolymer
 Printing: Raised Copy Only - Match D3
 Color: Painted - Panel and edges Match P3
 Rule Line: Mask + Spray - Paint P2
 Mounting: VHB Tape + Silicone to Wall Surface as reqd.
- 1A ADA Copy - Lettering**
 Raised Photopolymer
 Typeface: T1/T2
 Size: 5/8" Cap Height
 Case: Upper Case Only
 Tracking: +75
- 1B ADA Copy - Braille**
 Raised Photopolymer, Redundant Grade 2 Braille Copy
 Color: Match ADA Panel

SPECIFICATIONS

- 1 Room ID Sticker
Material: V2
Type: T2
Print: Match to D3

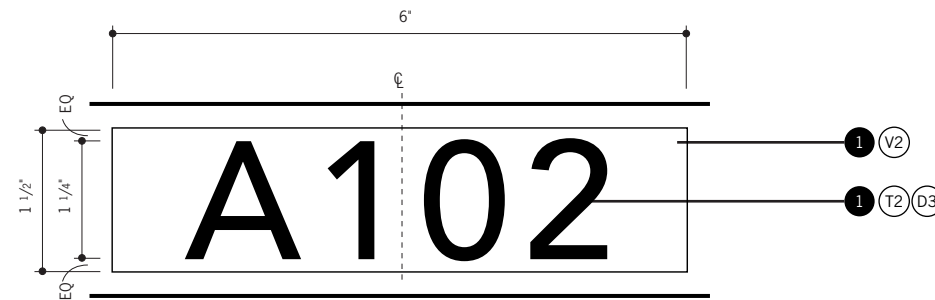

D8 - ROOM ID
Scale: 1:2



ELEVATION - Plan View
Scale: 1:2

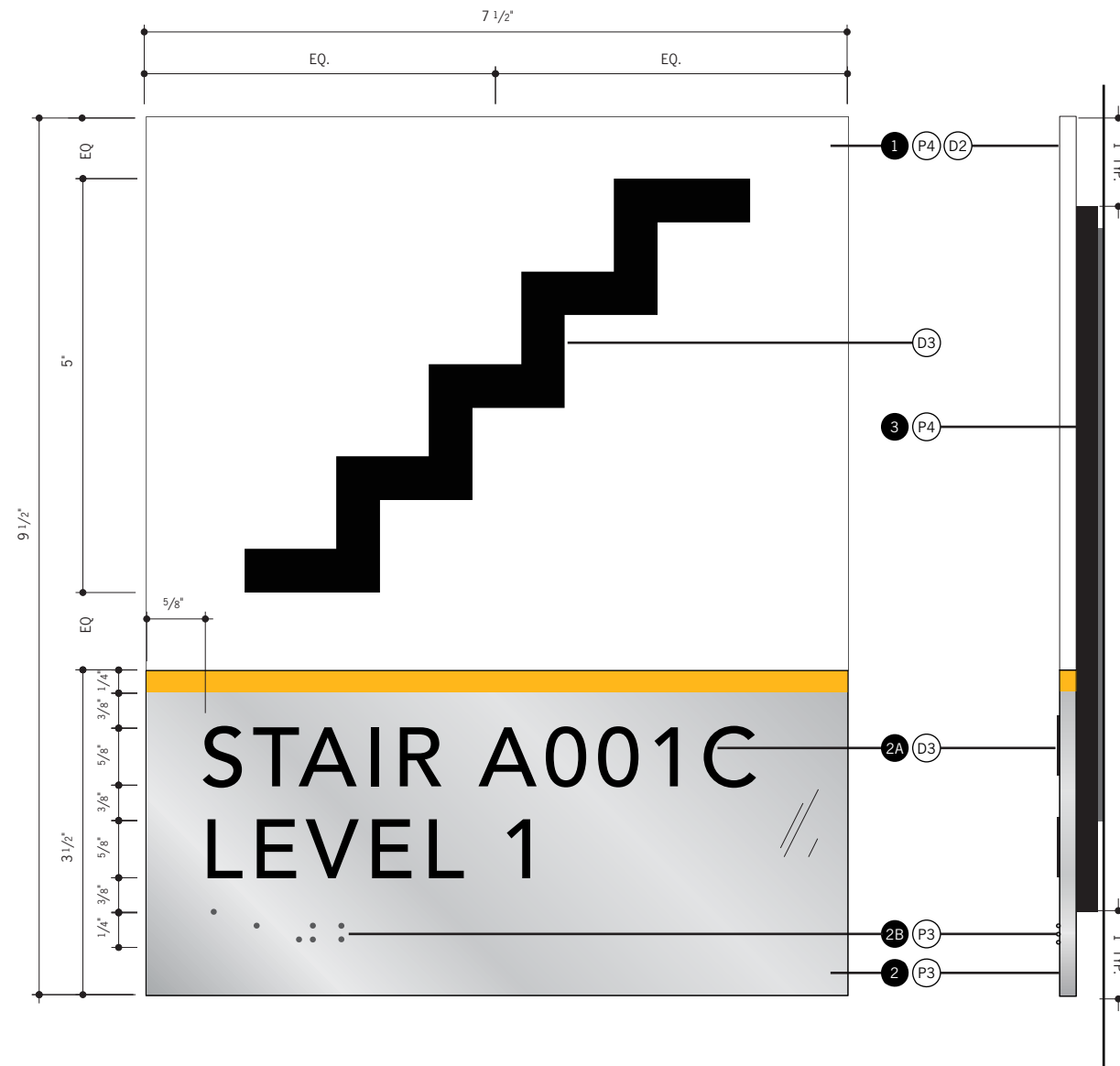

ELEVATION - R1 w/ Typical Specifications
Scale: 1:2

SPECIFICATIONS

- 1 Symbol Panel**
 Material: 3/16" Thk. Acrylic
 Color: Painted - Panel and edges painted P4
 Printing: Match D3 / D4
 Mounting: Secure to Back Plate w/ removable fasteners
- 2 ADA Panel**
 Material: 3/16" Thk. Photopolymer
 Printing: Raised Copy Only - Match D3
 Color: Painted - Match P3
 Rule Line: Mask + Spray - Paint P2
 Mounting: Secure to Back Plate w/ removable fasteners
- 2A ADA Copy - Lettering**
 Raised Photopolymer
 Typeface: T1/T2
 Size: 5/8" Cap Height
 Case: Upper Case Only
 Tracking: +75
- 2B ADA Copy - Braille**
 Raised Photopolymer, Redundant Grade 2 Braille Copy
 Color: Match ADA Insert
- 3 Back Plate**
 Material: 1/4" Thk. #2025 Opaque Black Acrylic
 Mounting: Concealed Mechanical Fasteners to Wall



ELEVATION - Plan View
Scale: 1:2

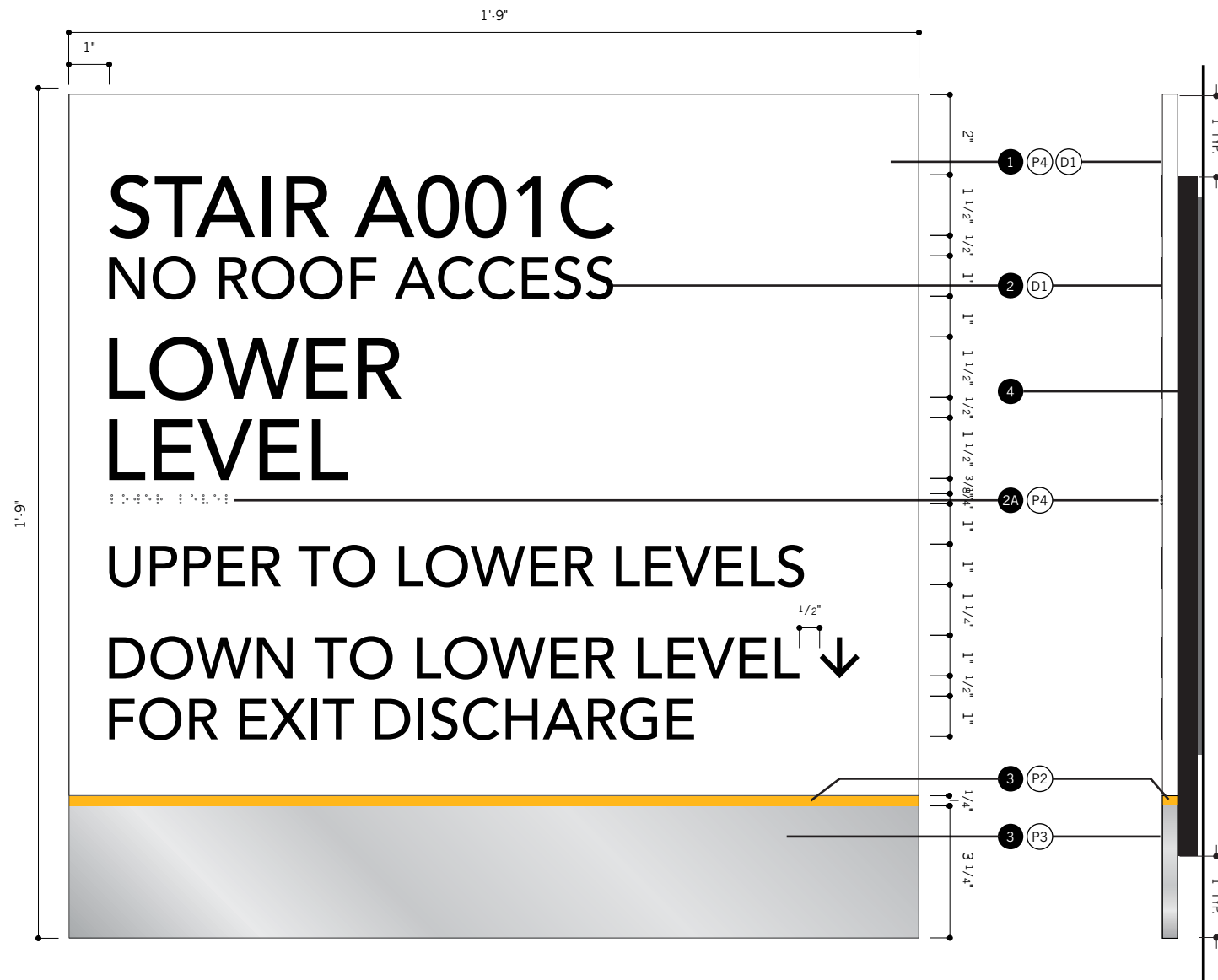

ELEVATION - R2 w/ Typical Specifications
Scale: 1:4

SPECIFICATIONS

- 1 **ADA Panel**
Material: 3/16" Thk. Acrylic
Color: Painted - Panel and edges painted P4
Printing: Match D1
Mounting: Laminated to Back Plate
- 2 **ADA Copy - Lettering**
Raised Photopolymer
Typeface: T1/T2
Size: 5/8" Cap Height
Case: Upper Case Only
Tracking: +75
- 2A **ADA Copy - Braille**
Raised Photopolymer, Redundant Grade 2 Braille Copy
Color: Match ADA Panel
- 3 **Accent Panel**
Material: 3/16" Thk. Acrylic
Color: Painted - Panel and edges painted P3
Rule: Painted - Mask + Spray edges painted P2
Mounting: Laminated to Back Plate
- 4 **Back Plate**
Material: 1/4" Thk. #2025 Opaque Black Acrylic
Mounting: Concealed Mechanical Fasteners to Wall

Area of Rescue ID - Overhead

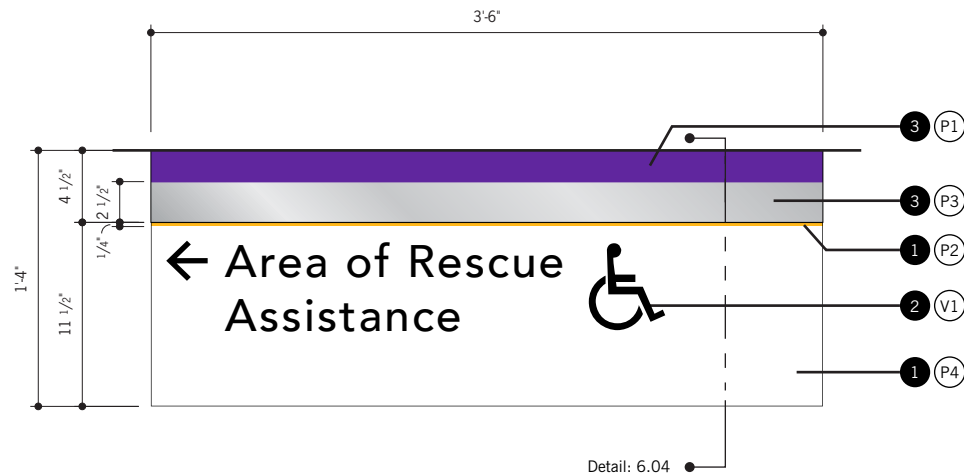

ELEVATION - R3 w/ Typical Specifications
Scale: 1" = 1'- 0"

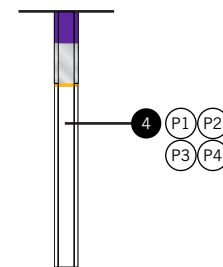

SIDE ELEVATION
Scale: 1" = 1'- 0"

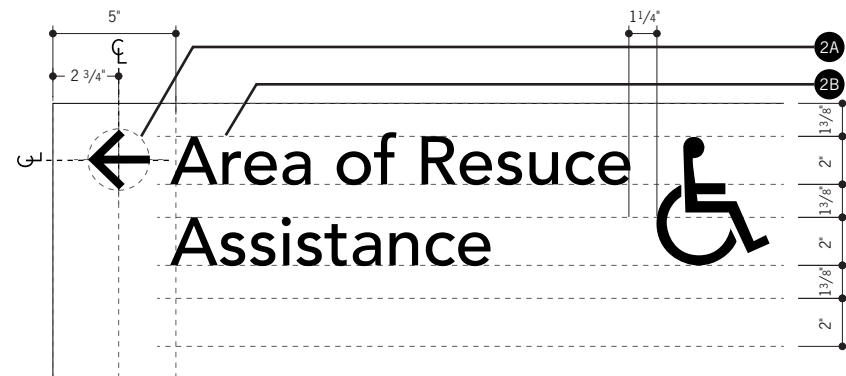

GRAPHIC LAYOUT (Left Aligned)
Scale: 1 1/2" = 1'- 0"

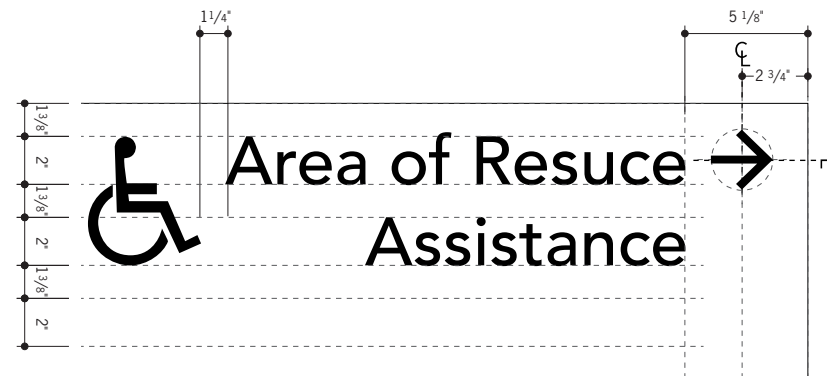

GRAPHIC LAYOUT (Right Aligned)
Scale: 1 1/2" = 1'- 0"

SPECIFICATIONS

- 1 **Sign Face**
Material: 1/4" Thk. Acrylic
Color: Backpainted - Match P4
Rule Line: Mask + Spray 1/4" H - Match P2
Mounting: D/F Tape Mount to Sign Frame
- 2 **Sign Copy**
Cut + Applied Vinyl
Color: Match V1
- 2A **Arrow**
Vector Artwork, See Graphic Standards
Size: 2 1/2" High
- 2B **Typeface: T2**
Size: 2" Cap Height
Case: Upper/Lower
Tracking: 0
- 2C **Typeface: T2**
Size: 1 1/2" Cap Height
Case: Upper Case
Tracking: +200
- 3 **Header**
Material: 1/4" Thk. Acrylic
Color: Painted - Match P1
Accent: Mask + Spray - Paint P3
Mounting: D/F Tape Mount to Sign Frame
- 4 **Sign Frame**
Material: 1" x 1" Aluminum Tube
Fabrication: Mitre-Cut + Welded Construction
Color: Mask + Spray Per Detail Drawing
Mounting: Flush-Mounted to Ceiling

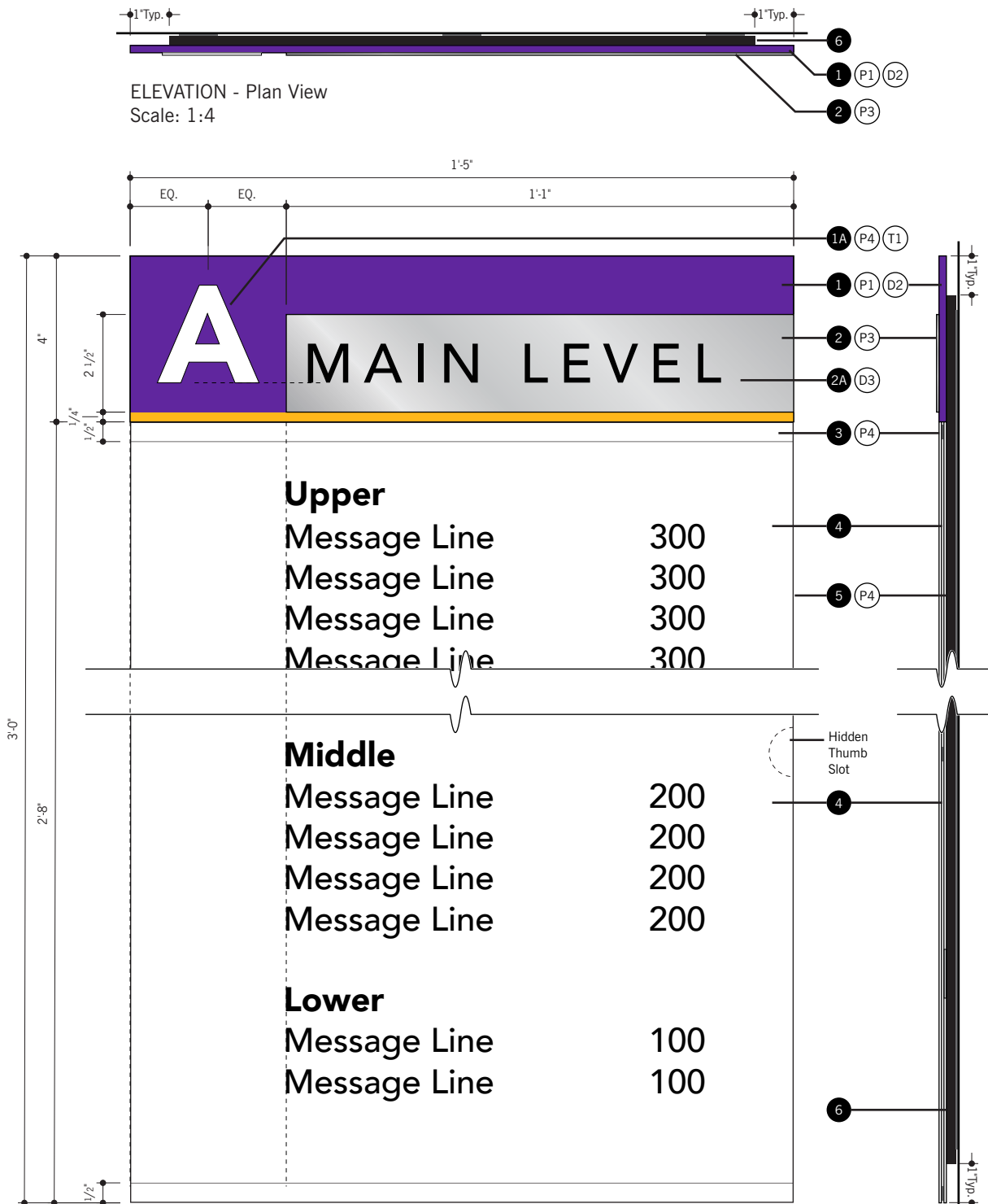

ELEVATION - II.1 w/ Typical Specifications
Scale: 1:4

SIDE ELEVATION
Scale: 1:4

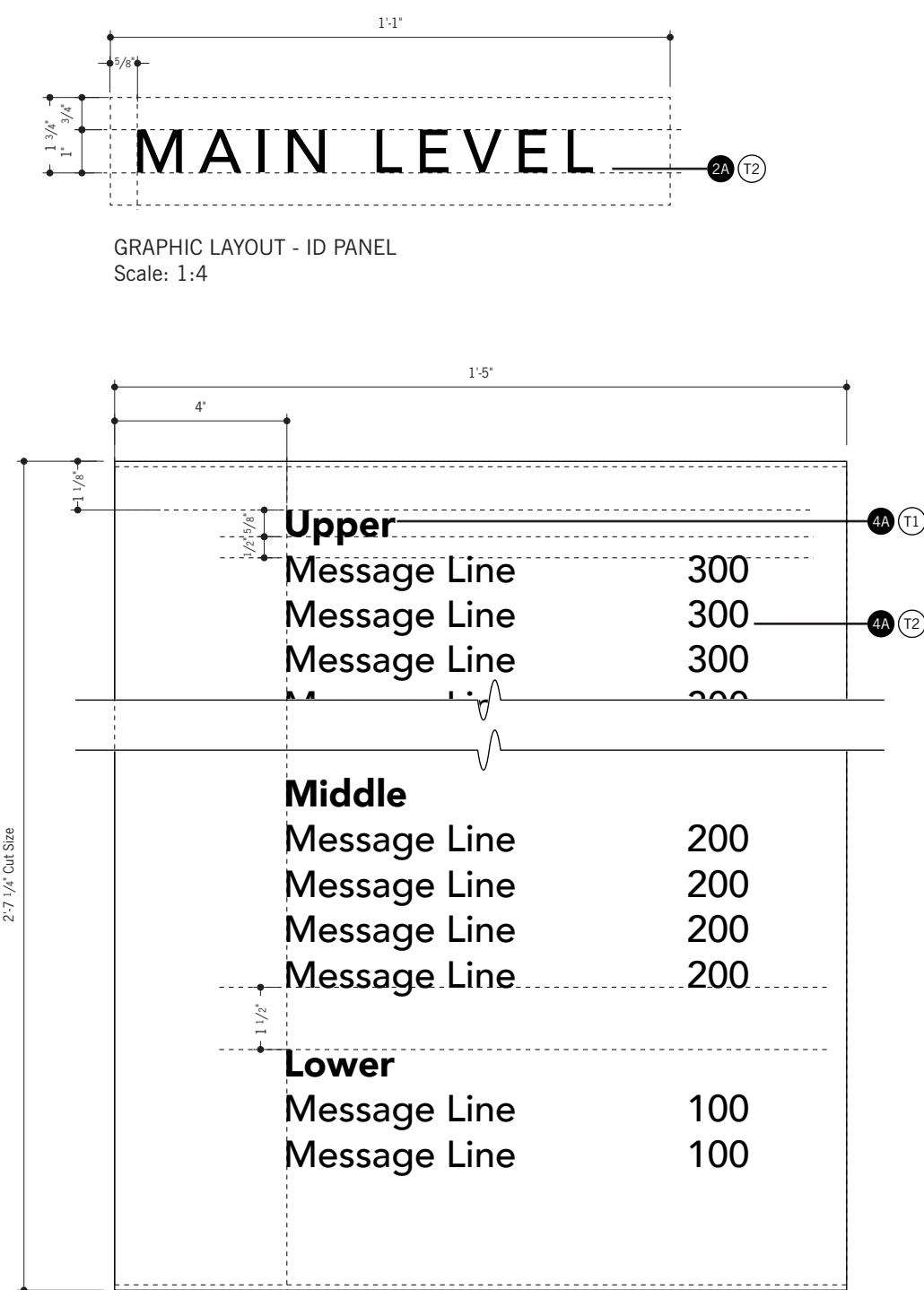

GRAPHIC LAYOUT - II.1 - PAPER INSERT
Scale: 1:4

SPECIFICATIONS

- 1 Header Panel**
Material: 3/16" Thk. Acrylic
Printing: Custom Rule Line - Match D2
Color: Painted - Match P1
Mounting: Secure to Back Plate w/ removable fasteners
- 1A Header Lettering**
Material: 1/16" Laser-Cut + Adhesive-Backed Acrylic
Typeface: T1
Size: 2 1/2" Cap Height
Case: Upper Case Only
Tracking: 0
Mounting: Laminated to Header Panel
- 2 ID Panel**
Material: 1/16" Thk. Acrylic
Printing: Direct Substrate Printed - Match D3
Color: Painted - Match P3
Mounting: Laminated to Header Panel
- 2A ID Lettering**
Typeface: T2
Size: 1" Cap Height
Case: Upper Case Only
Tracking: +200
- 3 Paper Insert Lens**
Material: 1/16" Thk. Clear Non-Glare Acrylic
Color: Mask + Spray 2nd Surface Band - Match P4
Mounting: 1/16" D/F Tape Mount to Insert Backer
- 4 Paper Insert**
Color: A00 White, Per Sign Standard
- 4A Insert Copy**
Laser Printed Graphics - See Graphic Layouts
Color: S1
Typeface: T1 Header / T2 Listing
Size: 5/8" Cap Height
Case: Upper/Lower
Tracking: 0
- 5 Paper Insert Backer**
Material: 1/16" Thk. Acrylic
Color: Paint P4 - All Surfaces
Mounting: Laminated to Back Plate
- 6 Back Plate**
Material: 1/4" Thk. #2025 Opaque Black Acrylic
Mounting: Concealed Mechanical Fasteners to Wall

Insert Holders - Wall Mounted

SPECIFICATIONS

- ① **Paper Insert Lens**
Material: 1/16" Thk. Clear Non-Glare Acrylic
Color: Mask + Spray 2nd Surface Band - Match P3
Mounting: 1/16" D/F Tape Mount to Insert Backer
- ② **Paper Insert**
Color: A00 White, Per Sign Standard
- ②A **Insert Copy**
Laser Printed Graphics - by Client
- ③ **Paper Insert Backer**
Material: 1/16" Thk. Acrylic
Color: Paint P3 - All Surfaces
Mounting: Laminated to Back Plate
- ④ **Back Plate**
Material: 1/4" Thk. #2025 Opaque Black Acrylic
Mounting: Concealed Mechanical Fasteners to Wall



ELEVATION - Plan View
Scale: 1:2

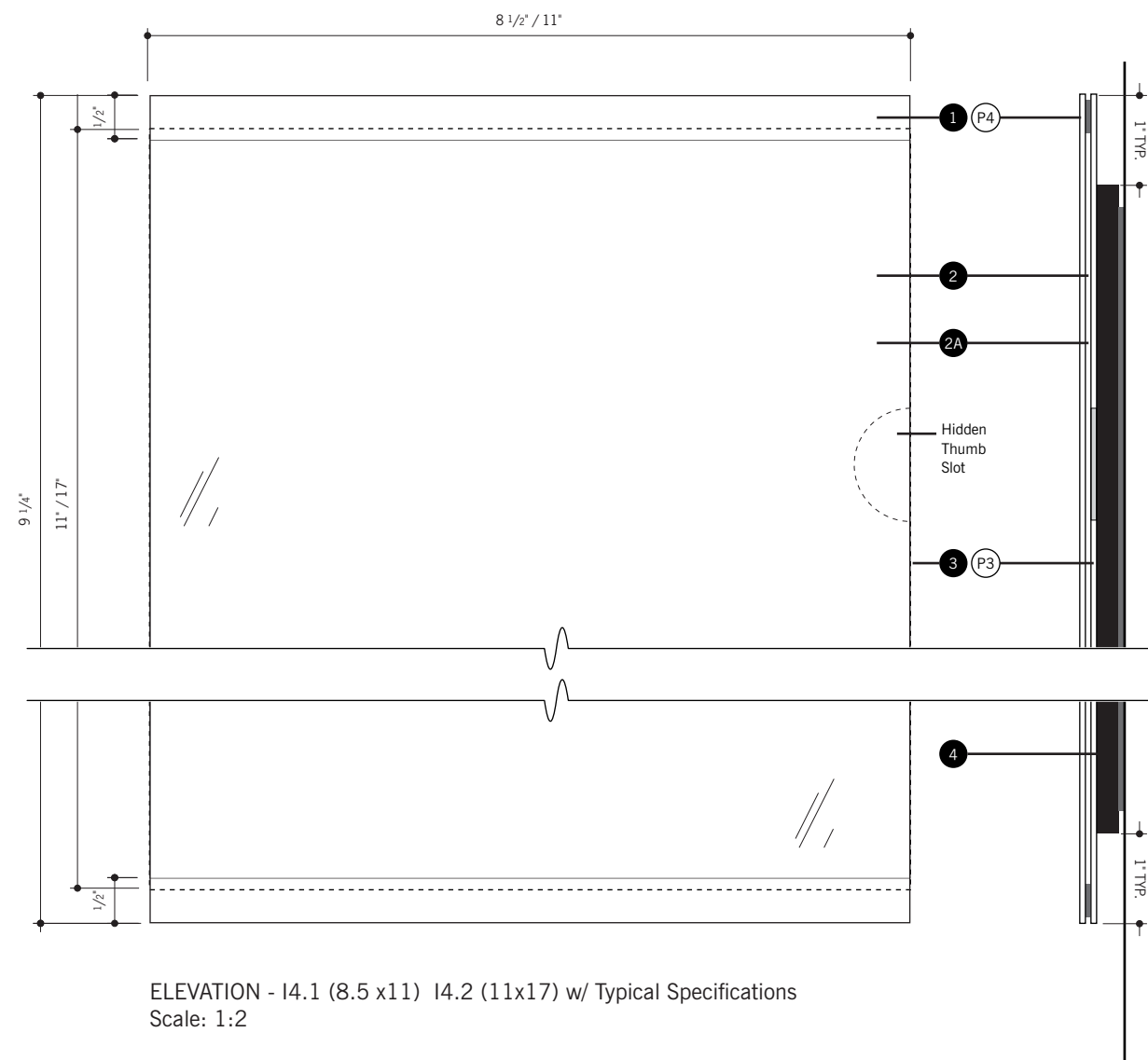

ELEVATION - I4.1 (8.5 x 11) I4.2 (11x17) w/ Typical Specifications
Scale: 1:2

I4.1
8.5" x 11"
Info Insert
Changeable

I4.2
11" x 17"
Info Insert
Changeable

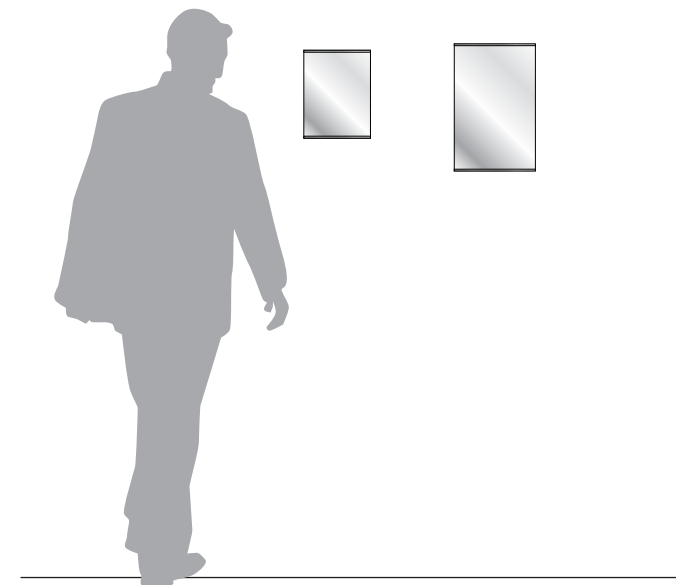

Parking Lot Banner - Pole Mounted

SPECIFICATIONS

- 1 **SIGN TRIANGLE**
 Material: Fabricated aluminum, 3-sided as shown
 Background Process: Surface painted, all exposed areas
 Colors: Mask + Spray - As Noted
 Artwork: By Designer
 Illuminated: No
 Mounting: Connects to existing light posts with Custom fabricated aluminum Mounting Channel(s) + Bracket(s)
- 2 **ID NUMBER**
 Surface applied vinyl, all faces - Match V2
 Typeface: As noted
 Copy Height: 10.75" Tall
 Tracking: 0

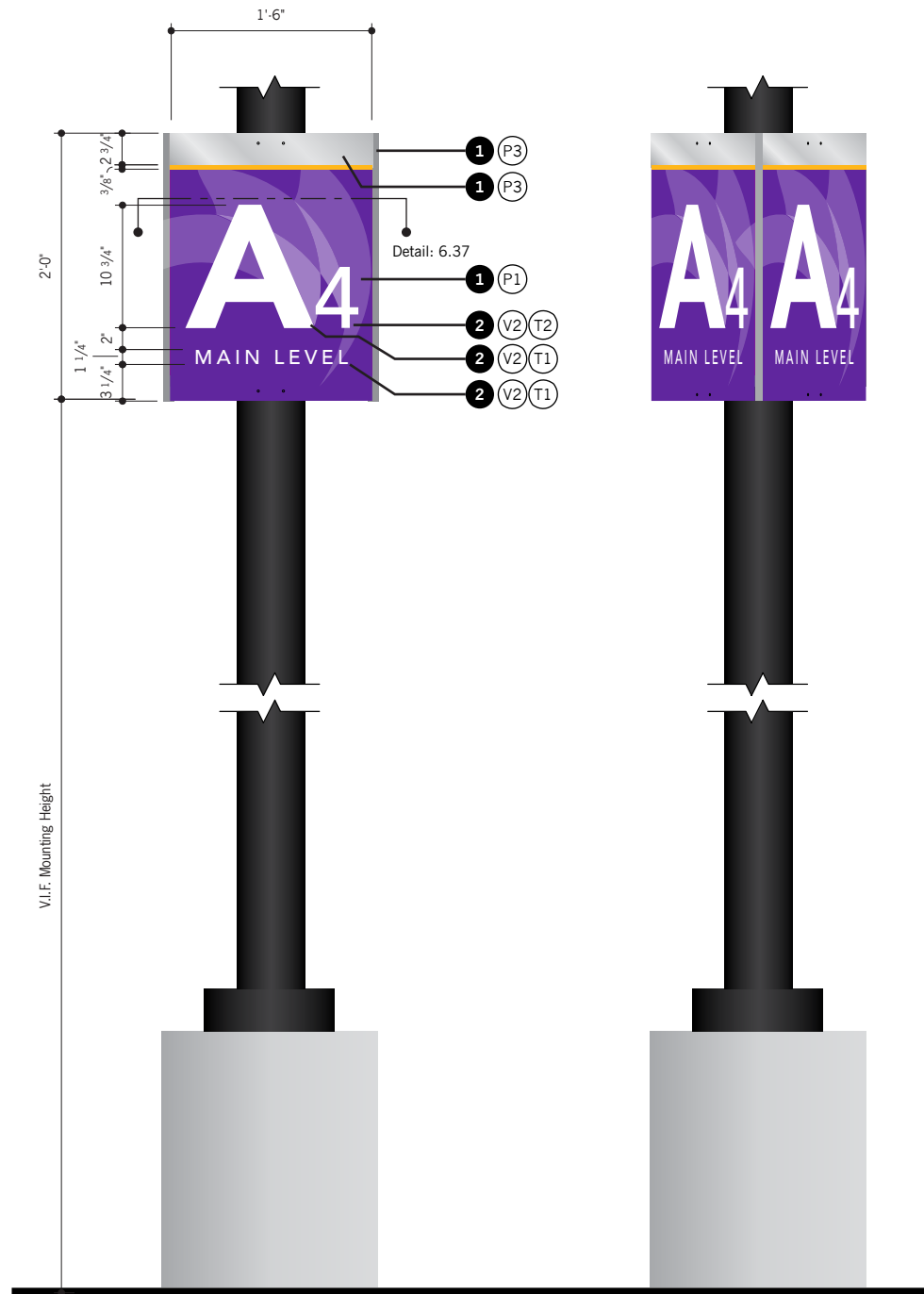

FRONT ELEVATION - P5.3
Scale: 3/4" = 1'-0"

SIDE ELEVATION - P5.3
Scale: 3/4" = 1'-0"



GRAPHIC VARIANTS
Scale: NTS

Parking Lot Banner - Pole Mounted

SPECIFICATIONS

- 1 Sign Face
1/8" thk. aluminum panel
Paint all surfaces - Per Elevation Detail
- 2 Corner Fastener(s)
1/4"-20 Weld Stud at rear or Sign Face w/ Nut + Washer
- 3 Corner Channel Bracket
1/8" thk. break formed aluminum channel
Paint P3
- 4 Sign Face Fastener(s)
S.S. Hex Head Mounting Bolt, 3/8"-16-Thread w/
Rivet-Nut, Nut + Washer. Bolt length may vary per Lamp
Post diameter. Paint to match Sign Face
- 5 Mounting Channel(s)
2" x 4" x 1/8" break formed aluminum channel

GENERAL NOTES

- A. Sign Faces to have absolutely no "oil-canning"
- B. All painted finishes to have satin or eggshell finish, unless otherwise noted.
- C. All panels to have finished edges with color that wraps edges.
- D. All drawings to be stamped and scaled by a licensed engineer.

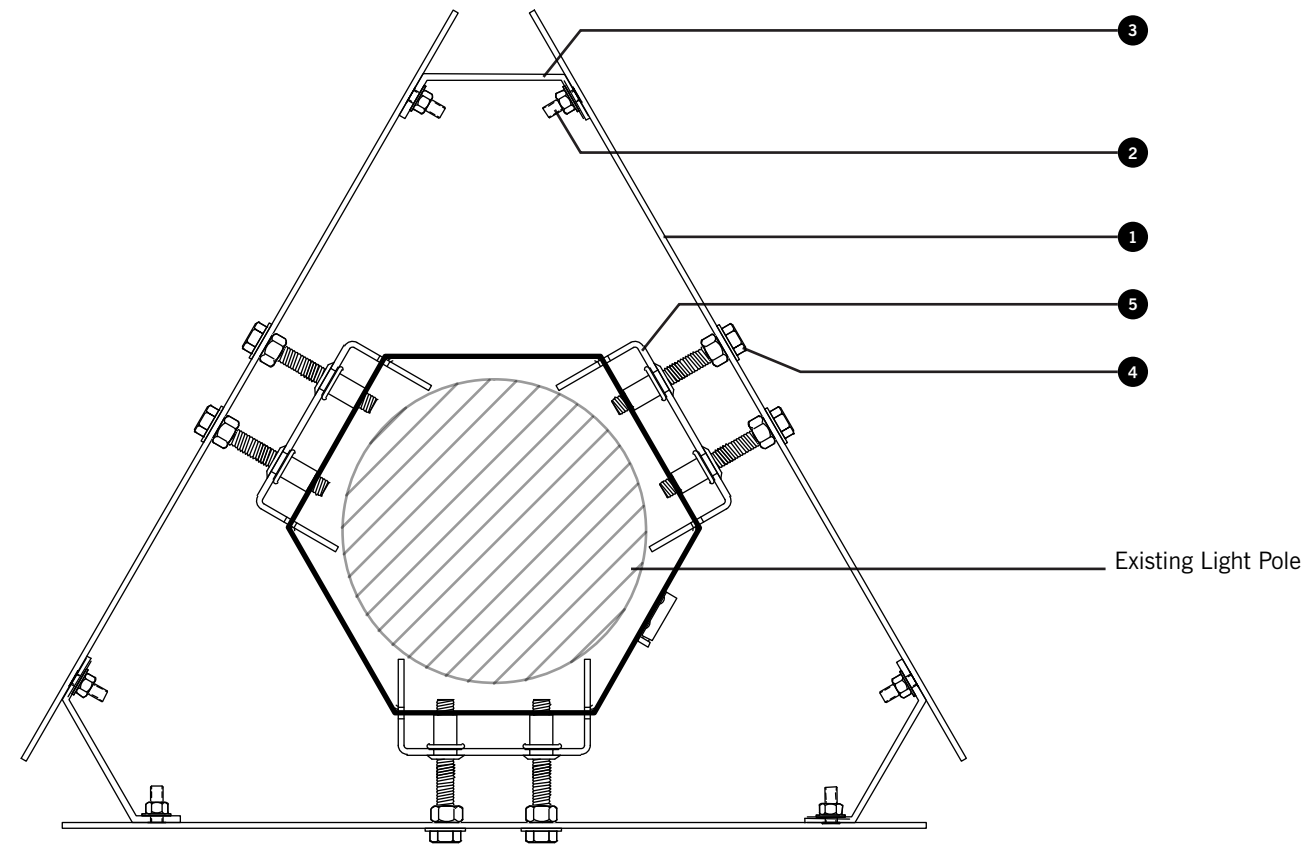

A SECTION - PLAN VIEW - P5.3
Scale: 3" = 1'- 0"